









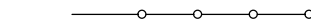

NOTES

1. COORDINATE SYSTEM IS UTM 12N REFERENCE TO ASCM 307521.
2. ALL DIMENSIONS ARE IN METERS UNLESS OTHERWISE NOTED.
3. SEE ENGINEERING DRAWINGS FOR SITE DETAIL.
4. REFER TO THE LANDSCAPE DRAWINGS FOR DETAILS.

LEGEND

-  SITE BOUNDARY
-  EXISTING RAIL CL
-  PROPOSED RAIL CL
-  EXISTING FENCE
-  PROPOSED FENCE
-  EXISTING POWER POLE
-  PROPOSED LIGHT DUTY ASPHALT PAVEMENT
-  PROPOSED GRAVEL PAVEMENT
-  EXISTING WETLAND
-  PROPOSED LANDSCAPING

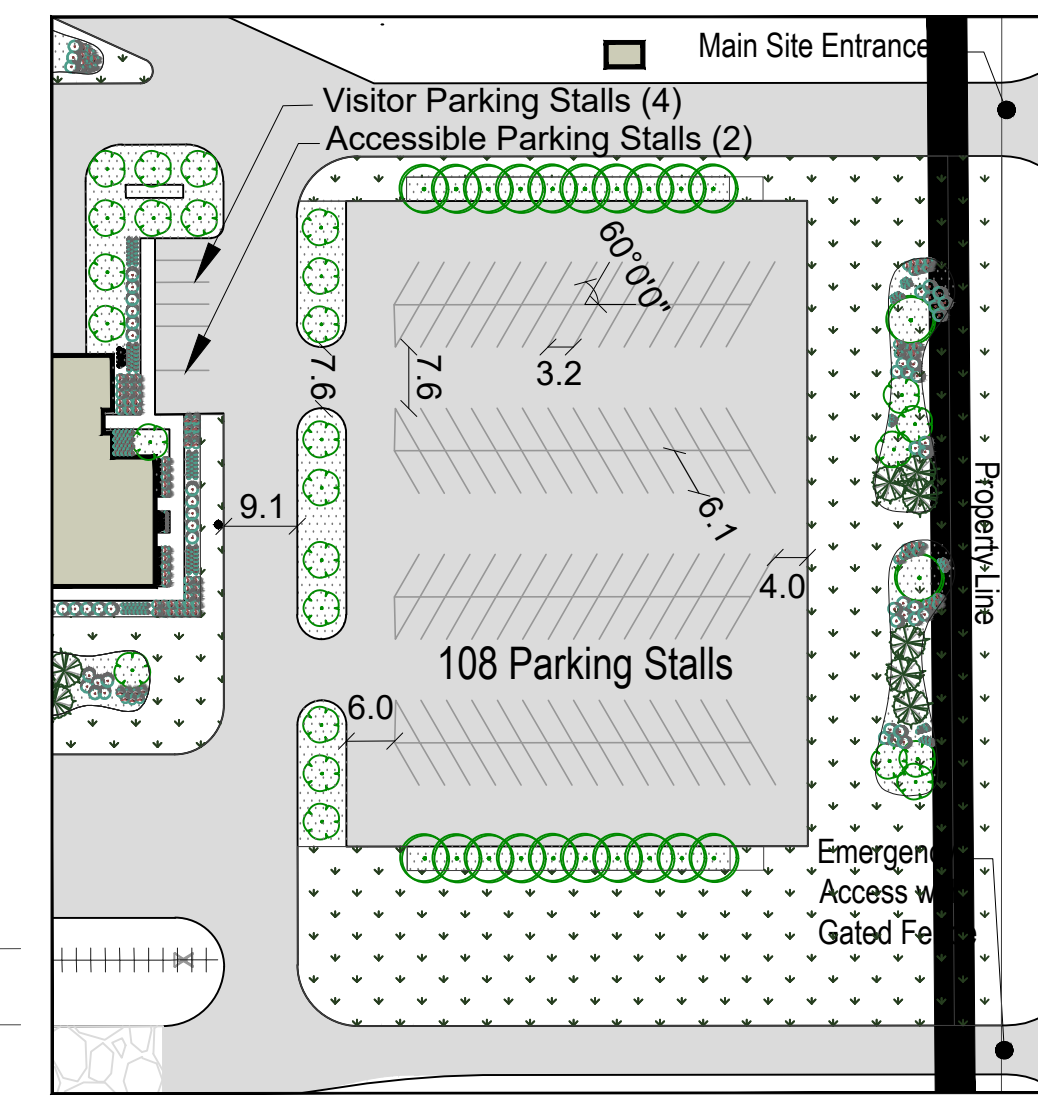
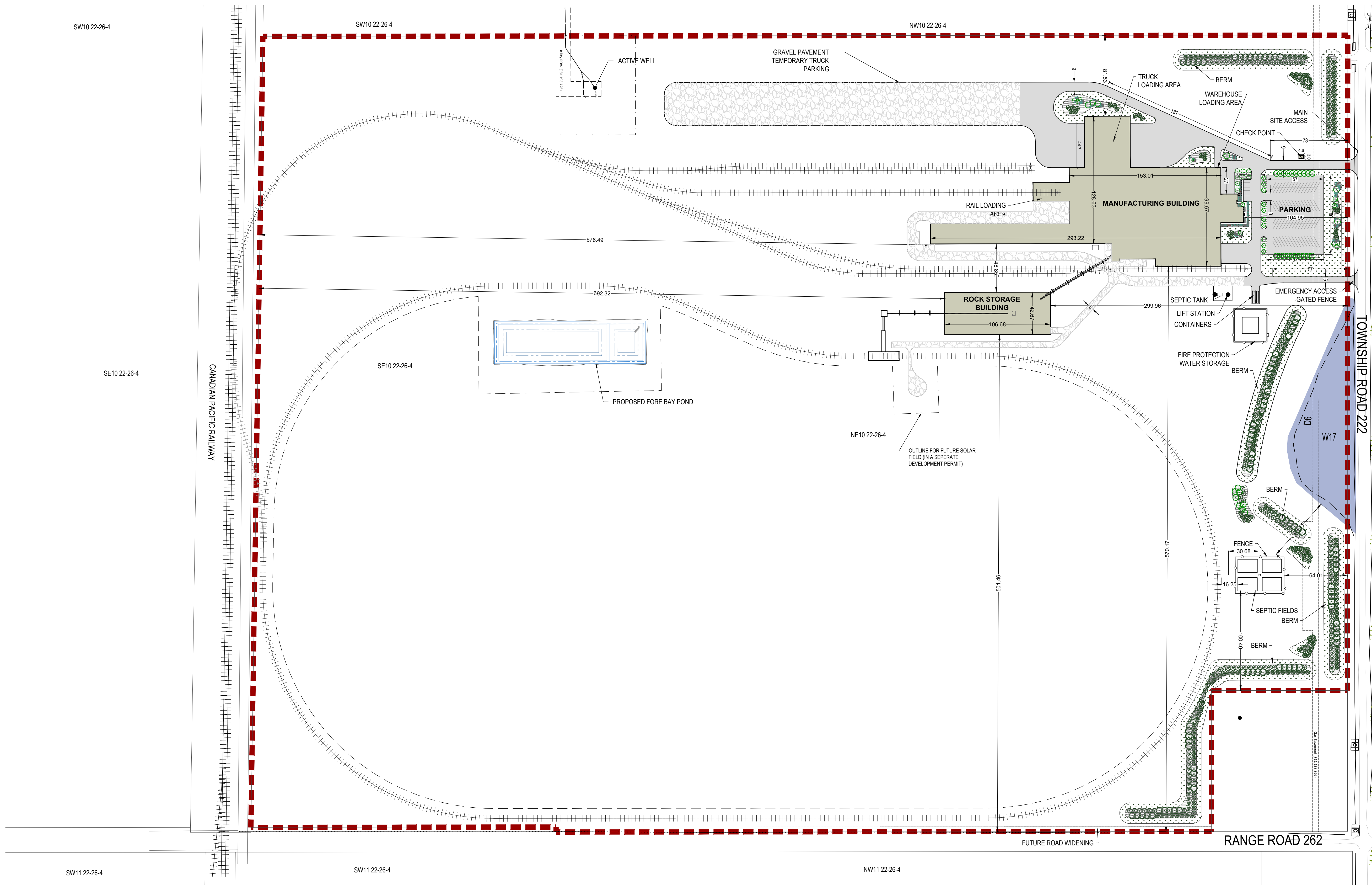

PRELIMINARY
 NOT FOR DESIGN OR CONSTRUCTION

CONFIDENTIAL

100% COMPLETE

This Engineering document and all information herein are the property of USG Corporation or one of its subsidiaries ("USGC") and are CONFIDENTIAL. They are to be used only in connection with the work you are doing on behalf of USGC. Their disclosure to a third party or non-employee may only be made under an appropriate confidentiality agreement with the prior written permission of USGC or its authorized representative.



REVISIONS	REVISIONS	REVISIONS	CONTROL NUMBER	0 1 2 3 4 5	DRAWN BY:	TLM	COPYRIGHT NOTICE	CGC	WSP	ARCHITECTURE	49	DRAWING NUMBER
				6 7 8 9 10 11	CHECKED BY:		UNITED STATES GYPSUM COMPANY @ 2023	IT'S YOUR WORLD BUILT BY	PLANT - WHEATLAND			WAB31300
C JAN 2024 ISSUED FOR DEVELOPMENT PERMIT APPROVAL					APPROVED BY:		THIS DRAWING IN DESIGN AND DETAILS IS THE PROPERTY OF THE USGC CORPORATION AND MUST NOT BE USED EXCEPT IN CONNECTION WITH OUR WORK. ALL RIGHTS OF DESIGN OR INVENTION ARE RESERVED.	USG PROJECT NO. 47092	ADDRESS - 262033 TWP RD 222, WHEATLAND, ALBERTA			
B OCT 2023 ISSUED FOR APPROVAL					ISSUED BY:			WSP PROJECT NO. 211-11100-00				REV. C
A AUG 2023 ISSUED FOR APPROVAL												
NO. DATE ISSUED	NO. DATE ISSUED	NO. DATE ISSUED										

SCALE: 1:2000

DEVELOPMENT PERMIT DRAWING

PRINT DATE: