

LEGEND

| | |
|----------|---|
| [Symbol] | LIMIT OF SHEET |
| [Symbol] | EXISTING GROUND CONTOURS (0.25m INTERVAL) |
| [Symbol] | EXISTING RAIL CL |
| [Symbol] | PROPOSED RAIL CL |
| [Symbol] | EXISTING GAS LINE |
| [Symbol] | PROPOSED GAS LINE |
| [Symbol] | EXISTING OVERHEAD POWER LINE |
| [Symbol] | PROPOSED UNDERGROUND POWER SERVICE |
| [Symbol] | EXISTING UNDERGROUND COMMUNICATION LINE |
| [Symbol] | PROPOSED UNDERGROUND COMMUNICATION LINE |
| [Symbol] | PROPOSED WATER LINE |
| [Symbol] | EXISTING CULVERT |
| [Symbol] | EXISTING FENCE |
| [Symbol] | PROPOSED FENCE |
| [Symbol] | EXISTING POWER POLE |
| [Symbol] | EXISTING COMMUNICATION PEDESTAL |
| [Symbol] | PROPOSED TOE OF BERM |

NOTES

- COORDINATE SYSTEM IS UTM 12N REFERENCE TO ASCM 397521.
- ALL DIMENSIONS ARE IN METERS UNLESS OTHERWISE NOTED.
- CONFIRM INVERTS OF ALL EXISTING UTILITIES, NOTIFY LANDSCAPE ARCHITECT OF ANY DISCREPANCIES.
- ALL AREAS OF DISTURBANCE TO BE SEEDED. EXTENTS SHOWN ARE APPROXIMATE ONLY.

PLANT SCHEDULE OVERALL

| CODE | QTY | BOTANICAL / COMMON NAME | TYPE | SIZE | REMARKS |
|----------------------|------------------------|---|--------|----------|--|
| TREES | | | | | |
| PC | 165 | Picea pungens / Colorado Spruce | B & B | 1.0m Ht. | Mature Spread: 7.0 M; Spacing: 5.0 M |
| PG | 130 | Picea pungens 'Glauca' / Blue Colorado Spruce | B & B | 1.0m Ht. | Mature Spread: 6.0 M; Spacing: 5.0 M |
| PS | 100 | Pinus sylvestris / Scotch Pine | B & B | 1.0m Ht. | Mature Spread: 10.0 M; Spacing: 5.0 M |
| SI | 14 | Syringa reticulata 'Ivory Silk' / Ivory Silk Japanese Tree Lilac | B & B | 40mm Cal | Mature Spread: 6.0 M; Spacing: 3.0 M |
| TD | 22 | Tilia x flavescens 'Droptmore' / Droptmore Linden | B & B | 40mm Cal | Mature Spread: 8.0 M; Spacing: 4.0 M |
| SHRUBS | | | | | |
| Ca | 33 | Cornus alba 'Ivory Halo' / Ivory Halo Dogwood | GALLON | #5 | Mature Spread: 2.0 M; Spacing: 1.5 M |
| Pp | 71 | Pinus mugo pumilio / Dwarf Mugo Pine | GALLON | #5 | Mature Spread: 1.5 M; Spacing: 1.2 M |
| Pa | 51 | Potentilla fruticosa 'Abbotswood' / Abbotswood Bush Cinquefoil | GALLON | #5 | Mature Spread: 1.0 M; Spacing: 0.75 M |
| Sa | 47 | Symphoricarpos albus / Common White Snowberry | GALLON | #5 | Mature Spread: 1.0 M; Spacing: 0.75 M |
| GRASSES | | | | | |
| CI | 44 | Calamagrostis x acutiflora 'Karl Foerster' / Karl Foerster Reed Grass | GALLON | #1 | Mature Spread: 0.75 M; Spacing: 0.60 M |
| GROUND COVERS | | | | | |
| ng | 99 288 m ² | Native Ground Cover (Salvaged & Reused) | seed | | |
| se | 106 381 m ² | Seed Mix | seed | | Complete with 150mm depth topsoil |
| sd | 3 011 m ² | Sod Mix | sod | | Complete with 130mm depth topsoil |

MATERIALS SCHEDULE OVERALL

| DESCRIPTION | QTY |
|--------------------------------------|-----------------------|
| PLANTING BED - TOPSOIL (600mm DEPTH) | 10 458 m ² |
| GRAVEL PAVING | 2 902 m ² |

LANDSCAPING REQUIREMENTS

PROPOSED LANDSCAPING TO FOLLOW THE WHEATLAND COUNTY LANDSCAPE & SCREENING GUIDELINES:
 TOTAL AREA OF PROPOSED LANDSCAPING + AREAS OF DISTURBANCE: 219,136 M²

LANDSCAPE TYPE 1: FULL SCREENING & NOISE MITIGATION (SEE DETAIL 01/WAB90106).
 100% SCREENING, 100% CONIFEROUS TREES ATOP A 1.8M HEIGHT BERM.

LANDSCAPE TYPE 2: PARTIAL SCREENING & NOISE MITIGATION (SEE DETAIL 02/WAB90106).
 50% SCREENING, 75% CONIFEROUS TREES, 25% DECIDUOUS TREES, 50% CONIFEROUS AND 50% DECIDUOUS SHRUBS (APPROXIMATE).

LANDSCAPE TYPE 3: BUFFER SCREENING (SEE DETAIL 03/WAB90106).
 25% SCREENING, 100% DECIDUOUS TREES, 25% CONIFEROUS, 50% DECIDUOUS SHRUBS, AND 25% DECORATIVE GRASSES (APPROXIMATE).

01 LANDSCAPE PLAN - OVERALL
90100 SCALE: 1:2000

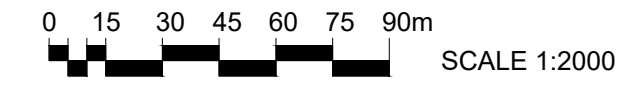

PRELIMINARY
NOT FOR DESIGN OR CONSTRUCTION

CONFIDENTIAL

USG CORPORATION
CONFIDENTIAL

This Engineering document and all information herein are the property of USG Corporation or one of its subsidiaries ("USGC") and are CONFIDENTIAL. They are to be used only in connection with the work you are doing on behalf of USGC. Their disclosure to a third party or non-employee may only be made under an appropriate confidentiality agreement with the prior written permission of USGC or its authorized representative.



| | | | | | | | |
|--|-----------------|-----------------|----------------|--|-----------------|--|-----------------------------------|
| REVISIONS | REVISIONS | REVISIONS | CONTROL NUMBER | 0 1 2 3 4 5 6 7 8 9 10 11 | DRAWN BY: NL | COPYRIGHT NOTICE UNITED STATES CIVIL SERVICE COMPANY @ 2023 | DRAWING NUMBER WAB90100 |
| | | | | Do Not Scale Drawing Right is Reserved to Make Changes at Our Option | CHECKED BY: RM | USG PROJECT NO. 47092 WSP PROJECT NO. 211-11100-00 | ARCHITECTURE 49 |
| | | | | SCALE: 1:2000 | APPROVED BY: RM | PLANT - WHEATLAND ADDRESS - 262033 TWP RD 222, WHEATLAND, ALBERTA | REV. B |
| B FEB. 2024 ISSUED FOR DEVELOPMENT PERMIT REVIEW | | | | | ISSUED BY: | LANDSCAPE PLAN - OVERALL | |
| A JAN. 2024 ISSUED FOR CLIENT REVIEW | | | | | | | |
| NO. DATE ISSUED | NO. DATE ISSUED | NO. DATE ISSUED | | | | | |

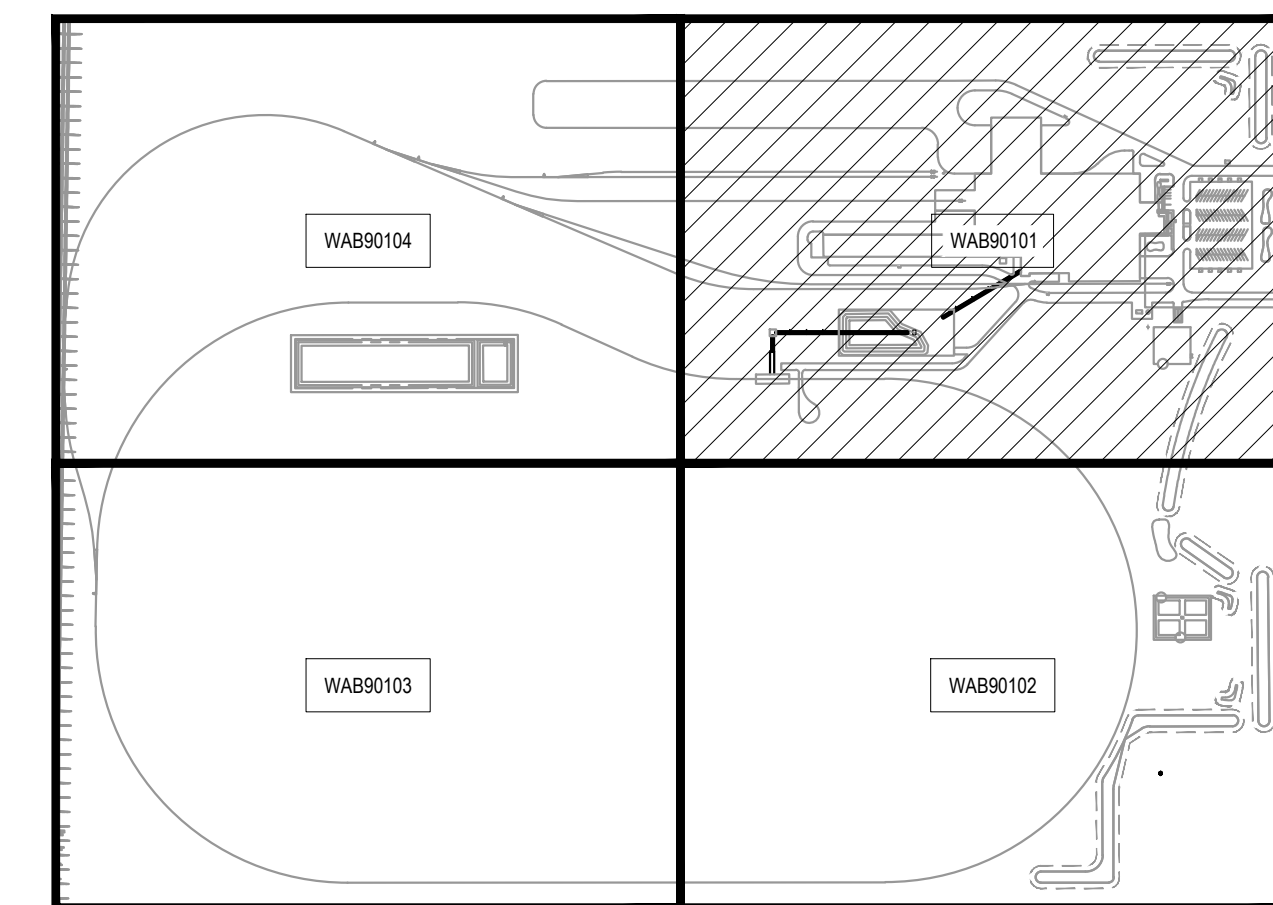
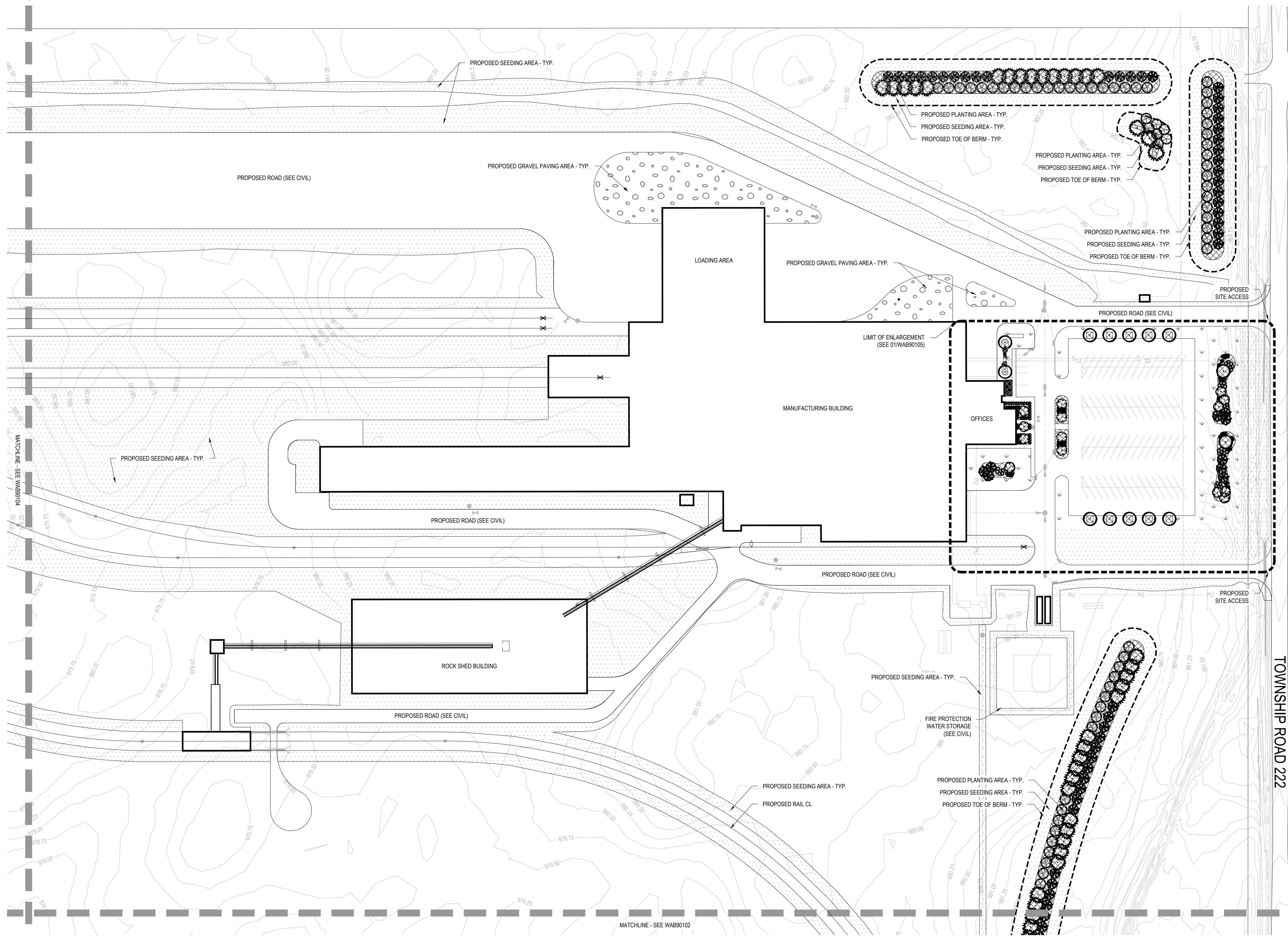
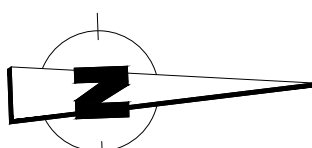

02 KEY PLAN
90101 SCALE: 1:7000

LEGEND

| | |
|--|---|
| | MATCHLINE |
| | EXISTING GROUND CONTOURS (0.25m INTERVAL) |
| | EXISTING RAIL CL |
| | PROPOSED RAIL CL |
| | EXISTING GAS LINE |
| | PROPOSED GAS LINE |
| | EXISTING OVERHEAD POWER LINE |
| | PROPOSED UNDERGROUND POWER SERVICE |
| | EXISTING UNDERGROUND COMMUNICATION LINE |
| | PROPOSED UNDERGROUND COMMUNICATION LINE |
| | PROPOSED WATER LINE |
| | EXISTING CULVERT |
| | EXISTING FENCE |
| | PROPOSED FENCE |
| | EXISTING POWER POLE |
| | EXISTING COMMUNICATION PEDESTAL |
| | PROPOSED TOE OF BERM |

NOTES

- COORDINATE SYSTEM IS UTM 12N REFERENCE TO ASCM 387521.
- ALL DIMENSIONS ARE IN METERS UNLESS OTHERWISE NOTED.
- CONFIRM INVERTS OF ALL EXISTING UTILITIES. NOTIFY LANDSCAPE ARCHITECT OF ANY DISCREPANCIES.
- ALL AREAS OF DISTURBANCE TO BE SEEDED. EXTENTS SHOWN ARE APPROXIMATE ONLY.

PLANT SCHEDULE

| SYMBOL | CODE | BOTANICAL / COMMON NAME | TYPE | SIZE | REMARKS |
|--------------|------|--|-------|----------|---------------------------------------|
| TREES | | | | | |
| | PC | Picea pungens / Colorado Spruce | B & B | 1.0m Ht. | Mature Spread: 7.0 M; Spacing: 5.0 M |
| | PG | Picea pungens 'Glauca' / Blue Colorado Spruce | B & B | 1.0m Ht. | Mature Spread: 6.0 M; Spacing: 5.0 M |
| | PS | Pinus sylvestris / Scotch Pine | B & B | 1.0m Ht. | Mature Spread: 10.0 M; Spacing: 5.0 M |
| | SI | Syringa reticulata 'Ivory Silk' / Ivory Silk Japanese Tree Lilac | B & B | 40mm Cal | Mature Spread: 6.0 M; Spacing: 3.0 M |
| | TD | Tilia x flavescens 'Dropmore' / Dropmore Linden | B & B | 40mm Cal | Mature Spread: 8.0 M; Spacing: 4.0 M |

| SYMBOL | CODE | BOTANICAL / COMMON NAME | CONT | SIZE | REMARKS |
|---------------|------|--|--------|------|---------------------------------------|
| SHRUBS | | | | | |
| | Ca | Cornus alba 'Ivory Halo' / Ivory Halo Dogwood | GALLON | #5 | Mature Spread: 2.0 M; Spacing: 1.5 M |
| | Pp | Pinus mugo pumilio / Dwarf Mugo Pine | GALLON | #5 | Mature Spread: 1.5 M; Spacing: 1.2 M |
| | Pa | Potentilla fruticosa 'Abbotswood' / Abbotswood Bush Cinquefoil | GALLON | #5 | Mature Spread: 1.0 M; Spacing: 0.75 M |
| | Sa | Symphoricarpos albus / Common White Snowberry | GALLON | #5 | Mature Spread: 1.0 M; Spacing: 0.75 M |

| SYMBOL | CODE | BOTANICAL / COMMON NAME | CONT | SIZE | REMARKS |
|----------------|------|---|--------|------|--|
| GRASSES | | | | | |
| | Ci | Calamagrostis x acutiflora 'Karl Foerster' / Karl Foerster Reed Grass | GALLON | #1 | Mature Spread: 0.75 M; Spacing: 0.60 M |

GROUND COVERS

| SYMBOL | CODE | DESCRIPTION | CONT | REMARKS |
|--------|------|---|------|-----------------------------------|
| | ng | Native Ground Cover (Salvaged & Reused) | sod | |
| | se | Seed Mix | seed | Complete with 150mm depth topsoil |
| | sd | Sod Mix | sod | Complete with 130mm depth topsoil |

MATERIALS SCHEDULE

| SYMBOL | DESCRIPTION |
|--------|--------------------------------------|
| | PLANTING BED - TOPSOIL (600mm DEPTH) |
| | GRAVEL PAVING |

01 LANDSCAPE PLAN
90101 SCALE: 1:1000

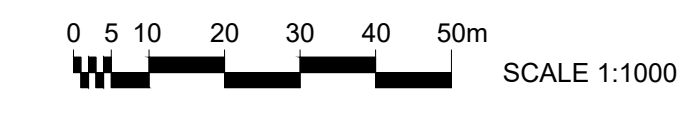

PRELIMINARY
NOT FOR DESIGN OR CONSTRUCTION

100% COMPLETE
XX

CONFIDENTIAL

This Engineering document and all information herein are the property of USG Corporation or one of its subsidiaries ("USGC") and are CONFIDENTIAL. They are to be used only in connection with the work you are doing on behalf of USGC. Their disclosure to a third party or non-employee may only be made under an appropriate confidentiality agreement with the prior written permission of USGC or its authorized representative.



| REVISIONS | REVISIONS | REVISIONS | CONTROL NUMBER | 0 1 2 3 4 5 | DRAWN BY: | COPYRIGHT NOTICE UNITED STATES CYPRUS COMPANY @ 2023 | CGC WSP ARCHITECTURE 49 | LANDSCAPE PLAN | DRAWING NUMBER | | |
|--|-----------------|-----------------|----------------|---------------|------------|--|---------------------------------|----------------|------------------------------|---|----------|
| | | | | 6 7 8 9 10 11 | NL | | | | USG PROJECT NO. 47092 | PLANT - WHEATLAND | WAB90101 |
| | | | | | RM | | | | WSP PROJECT NO. 211-11100-00 | ADDRESS - 262033 TWP RD 222, WHEATLAND, ALBERTA | |
| B FEB. 2024 ISSUED FOR DEVELOPMENT PERMIT REVIEW | | | | | RM | THIS DRAWING IS THE PROPERTY OF THE USG CORPORATION AND MUST NOT BE USED EXCEPT IN CONNECTION WITH OUR WORK. ALL RIGHTS OF DESIGN OR INVENTION ARE RESERVED. | | REV. B | | | |
| A JAN. 2024 ISSUED FOR CLIENT REVIEW | | | | | | LANDSCAPE PLAN | | | | | |
| NO. DATE ISSUED | NO. DATE ISSUED | NO. DATE ISSUED | | | ISSUED BY: | SCALE: 1:1000 | | PRINT DATE: | | | |

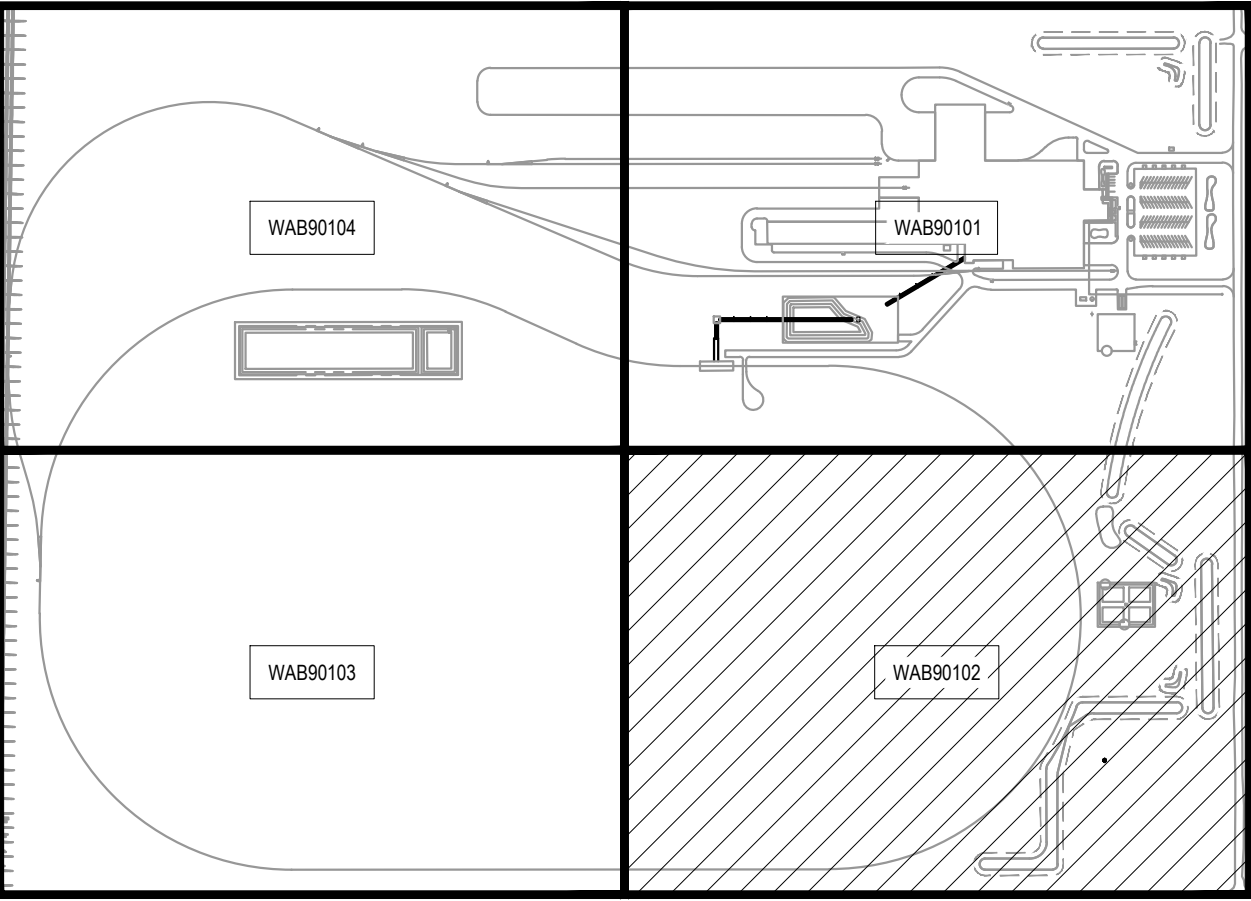
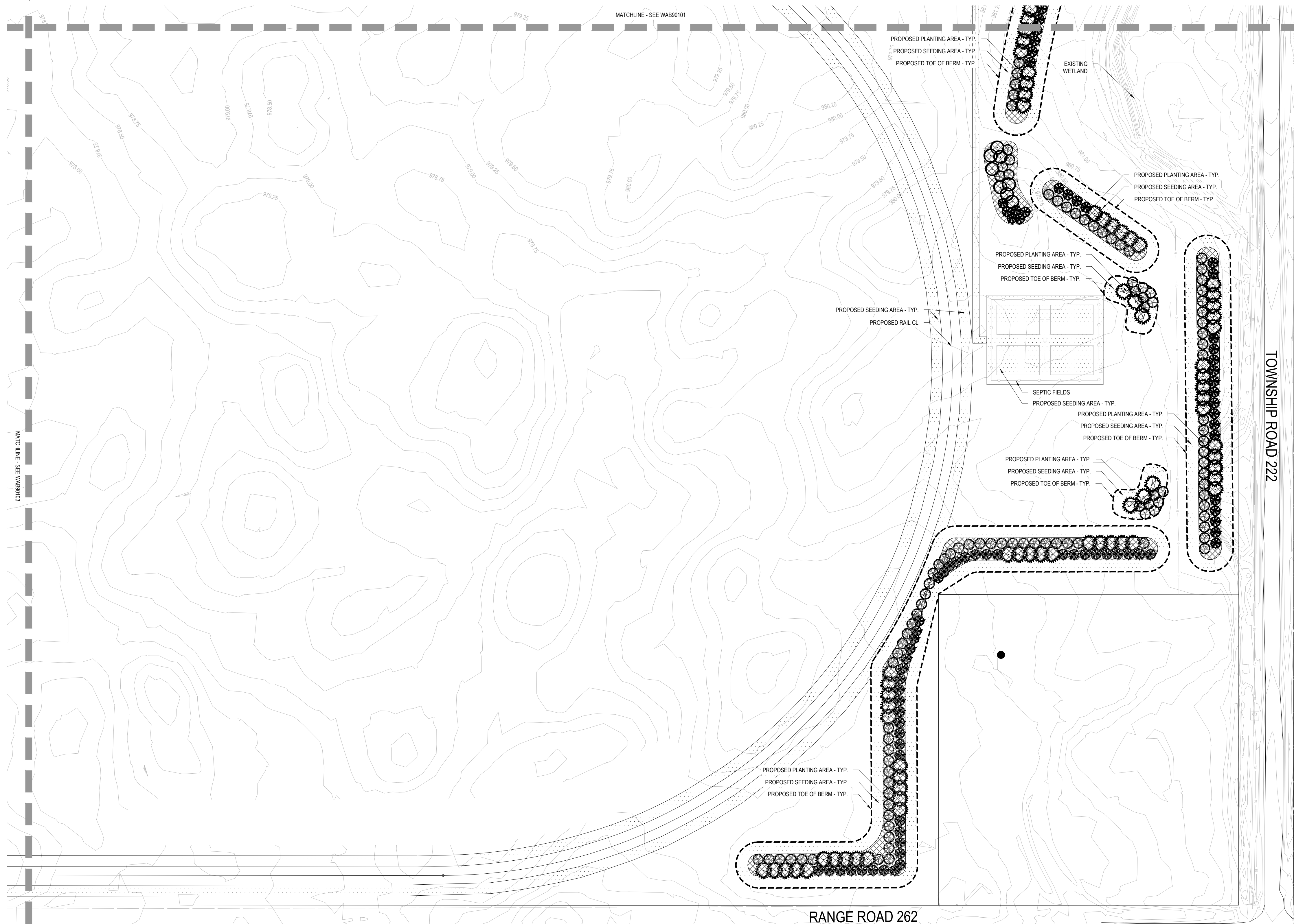
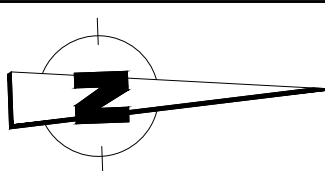

02 KEY PLAN
90102 SCALE: 1:7000

LEGEND

| | |
|--|---|
| | MATCHLINE |
| | EXISTING GROUND CONTOURS (0.25m INTERVAL) |
| | EXISTING RAIL CL |
| | PROPOSED RAIL CL |
| | EXISTING GAS LINE |
| | PROPOSED GAS LINE |
| | EXISTING OVERHEAD POWER LINE |
| | PROPOSED UNDERGROUND POWER SERVICE |
| | EXISTING UNDERGROUND COMMUNICATION LINE |
| | PROPOSED UNDERGROUND COMMUNICATION LINE |
| | PROPOSED WATER LINE |
| | EXISTING CULVERT |
| | EXISTING FENCE |
| | PROPOSED FENCE |
| | EXISTING POWER POLE |
| | EXISTING COMMUNICATION PEDESTAL |
| | PROPOSED TOE OF BERM |

NOTES

- COORDINATE SYSTEM IS UTM 12N REFERENCE TO ASCM 387521.
- ALL DIMENSIONS ARE IN METERS UNLESS OTHERWISE NOTED.
- CONFIRM INVERTS OF ALL EXISTING UTILITIES. NOTIFY LANDSCAPE ARCHITECT OF ANY DISCREPANCIES.
- ALL AREAS OF DISTURBANCE TO BE SEEDED. EXTENTS SHOWN ARE APPROXIMATE ONLY.

PLANT SCHEDULE

| SYMBOL | CODE | BOTANICAL / COMMON NAME | TYPE | SIZE | REMARKS |
|----------------|------|---|--------|----------|--|
| TREES | | | | | |
| | PC | Picea pungens / Colorado Spruce | B & B | 1.0m Ht. | Mature Spread: 7.0 M; Spacing: 5.0 M |
| | PG | Picea pungens 'Glauca' / Blue Colorado Spruce | B & B | 1.0m Ht. | Mature Spread: 6.0 M; Spacing: 5.0 M |
| | PS | Pinus sylvestris / Scotch Pine | B & B | 1.0m Ht. | Mature Spread: 10.0 M; Spacing: 5.0 M |
| | SI | Syringa reticulata 'Ivory Silk' / Ivory Silk Japanese Tree Lilac | B & B | 40mm Cal | Mature Spread: 6.0 M; Spacing: 3.0 M |
| | TD | Tilia x flavescens 'Dropmore' / Dropmore Linden | B & B | 40mm Cal | Mature Spread: 8.0 M; Spacing: 4.0 M |
| SHRUBS | | | | | |
| | Ca | Cornus alba 'Ivory Halo' / Ivory Halo Dogwood | GALLON | #5 | Mature Spread: 2.0 M; Spacing: 1.5 M |
| | Pp | Pinus mugo pumilio / Dwarf Mugo Pine | GALLON | #5 | Mature Spread: 1.5 M; Spacing: 1.2 M |
| | Pa | Potentilla fruticosa 'Abbotswood' / Abbotswood Bush Cinquefoil | GALLON | #5 | Mature Spread: 1.0 M; Spacing: 0.75 M |
| | Sa | Symphoricarpos albus / Common White Snowberry | GALLON | #5 | Mature Spread: 1.0 M; Spacing: 0.75 M |
| GRASSES | | | | | |
| | Ci | Calamagrostis x acutiflora 'Karl Foerster' / Karl Foerster Reed Grass | GALLON | #1 | Mature Spread: 0.75 M; Spacing: 0.60 M |

GROUND COVERS

| | | | | |
|--|----|---|------|-----------------------------------|
| | ng | Native Ground Cover (Salvaged & Reused) | sod | |
| | se | Seed Mix | seed | Complete with 150mm depth topsoil |
| | sd | Sod Mix | sod | Complete with 130mm depth topsoil |

MATERIALS SCHEDULE

| SYMBOL | DESCRIPTION |
|--------|--------------------------------------|
| | PLANTING BED - TOPSOIL (600mm DEPTH) |
| | GRAVEL PAVING |

01 LANDSCAPE PLAN
90102 SCALE: 1:1000

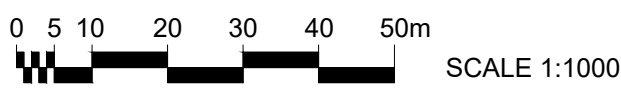

PRELIMINARY
NOT FOR DESIGN OR CONSTRUCTION

100% COMPLETE
XX

CONFIDENTIAL

This Engineering document and all information herein are the property of USG Corporation or one of its subsidiaries ("USGC") and are CONFIDENTIAL. They are to be used only in connection with the work you are doing on behalf of USGC. Their disclosure to a third party or non-employee may only be made under an appropriate confidentiality agreement with the prior written permission of USGC or its authorized representative.



| REVISIONS | REVISIONS | REVISIONS | CONTROL NUMBER |
|-------------|--------------------------------------|-----------|----------------|
| | | | |
| | | | |
| | | | |
| | | | |
| | | | |
| B FEB. 2024 | ISSUED FOR DEVELOPMENT PERMIT REVIEW | | |
| A JAN. 2024 | ISSUED FOR CLIENT REVIEW | | |
| NO. DATE | ISSUED | NO. DATE | ISSUED |

| | | | | | |
|--------------------|---|---|---|----|----|
| 0 | 1 | 2 | 3 | 4 | 5 |
| 6 | 7 | 8 | 9 | 10 | 11 |
| DRAWN BY: _____ | | | | | |
| CHECKED BY: _____ | | | | | |
| APPROVED BY: _____ | | | | | |
| ISSUED BY: _____ | | | | | |

| | |
|----|-------|
| NL | _____ |
| RM | _____ |
| RM | _____ |
| | _____ |
| | _____ |

Copyright Notice
UNITED STATES
GYPSUM
COMPANY @ 2023

THIS DRAWING IN DESIGN AND DETAILS IS THE PROPERTY OF THE USG CORPORATION AND MUST NOT BE USED EXCEPT IN CONNECTION WITH OUR WORK. ALL RIGHTS OF DESIGN OR INVENTION ARE RESERVED.

CGC **WSP** ARCHITECTURE | 49

USG PROJECT NO. 47092
211-11100-00

PLANT - WHEATLAND
ADDRESS - 262033 TWP RD 222, WHEATLAND, ALBERTA

LANDSCAPE PLAN

DRAWING NUMBER
WAB90102

REV. B

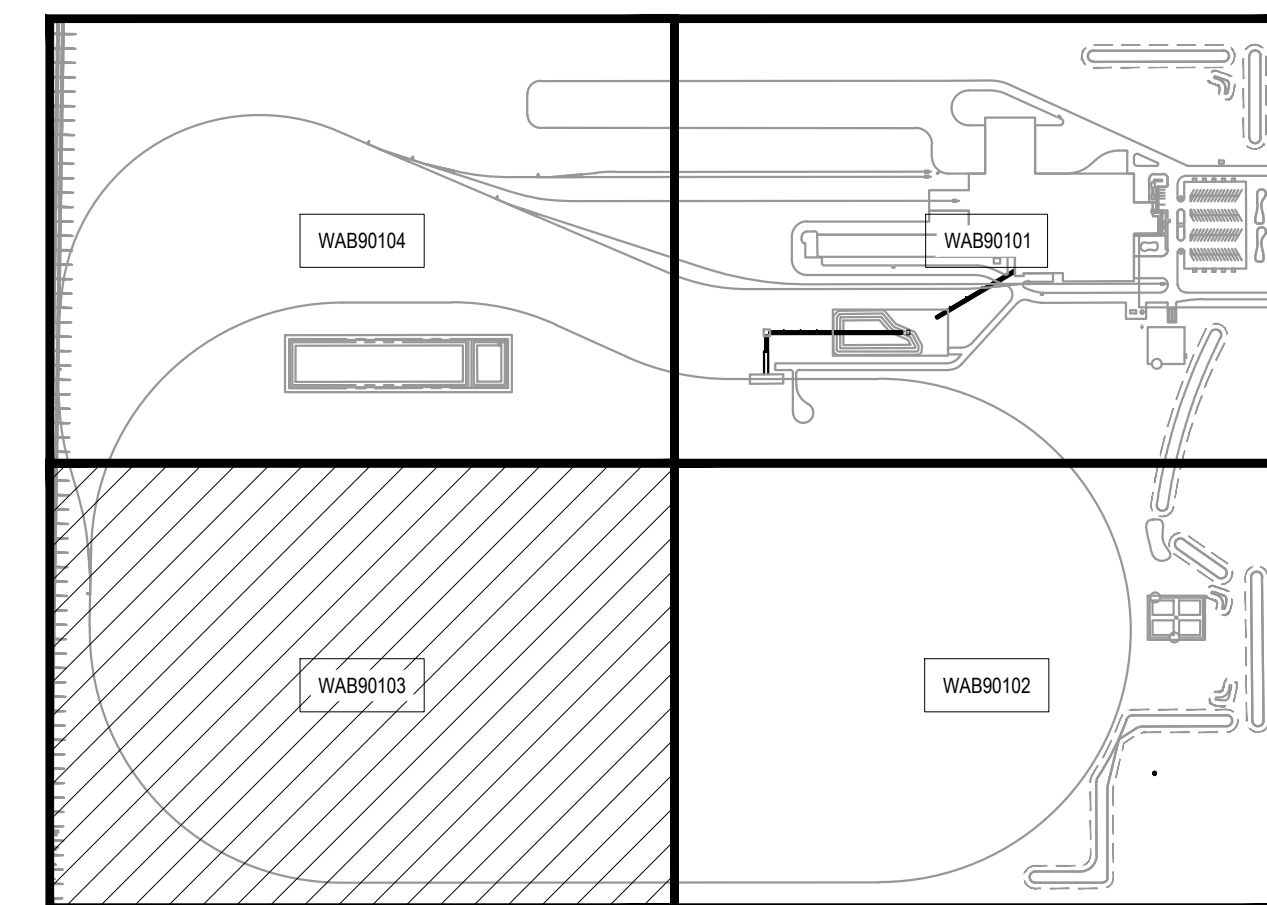
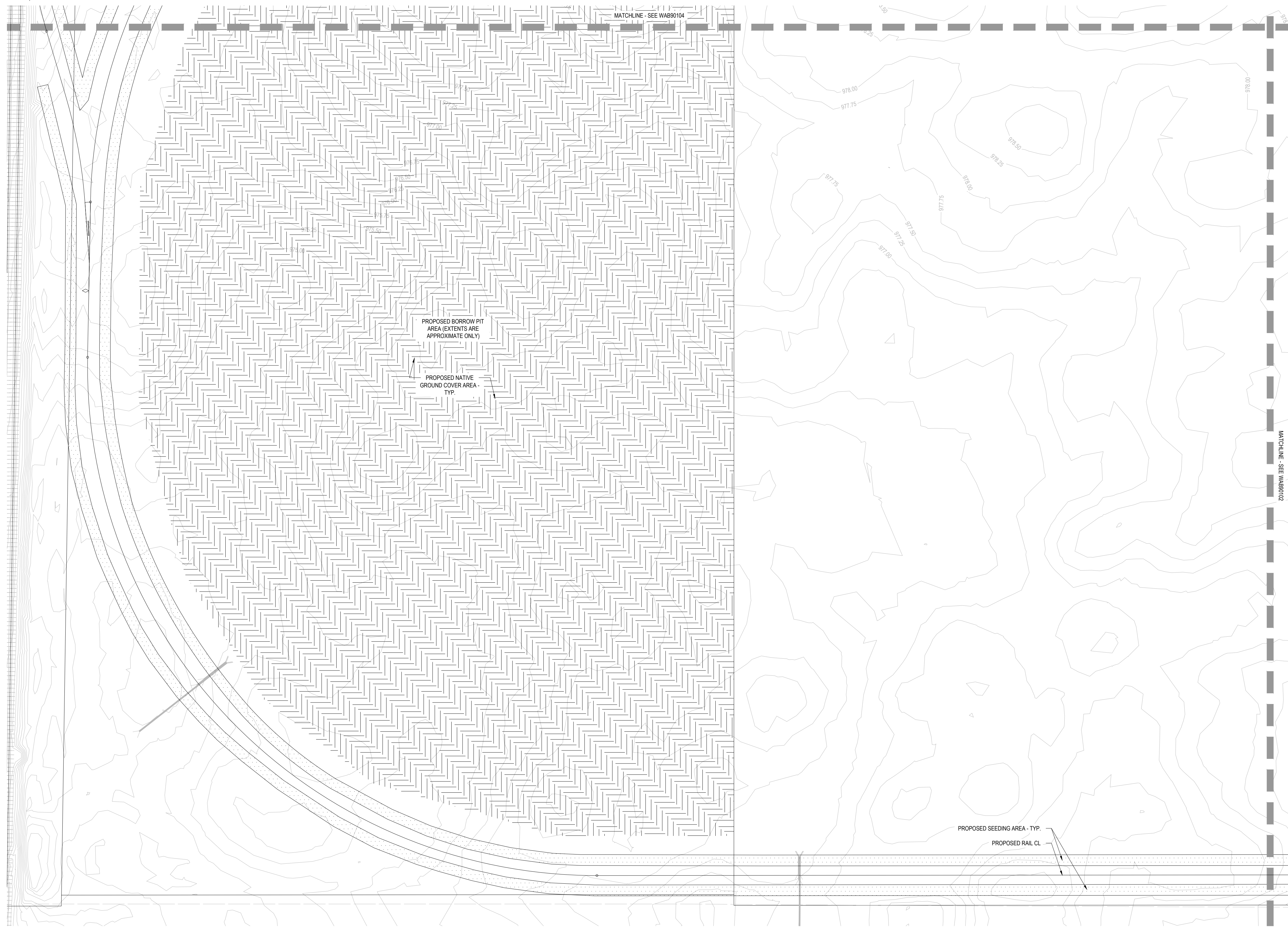
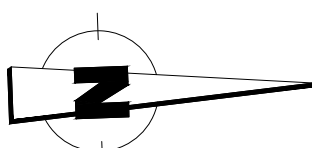

02 KEY PLAN
90103 SCALE: 1:7000

LEGEND

| | |
|--|---|
| | MATCHLINE |
| | EXISTING GROUND CONTOURS (0.25m INTERVAL) |
| | PROPOSED RAIL CL |
| | EXISTING GAS LINE |
| | PROPOSED GAS LINE |
| | EXISTING OVERHEAD POWER LINE |
| | PROPOSED UNDERGROUND POWER SERVICE |
| | EXISTING UNDERGROUND COMMUNICATION LINE |
| | PROPOSED UNDERGROUND COMMUNICATION LINE |
| | PROPOSED WATER LINE |
| | EXISTING CULVERT |
| | EXISTING FENCE |
| | PROPOSED FENCE |
| | EXISTING POWER POLE |
| | EXISTING COMMUNICATION PEDESTAL |
| | PROPOSED TOE OF BERM |

NOTES

- COORDINATE SYSTEM IS UTM 12N REFERENCE TO ASCM 387521.
- ALL DIMENSIONS ARE IN METERS UNLESS OTHERWISE NOTED.
- CONFIRM INVERTS OF ALL EXISTING UTILITIES. NOTIFY LANDSCAPE ARCHITECT OF ANY DISCREPANCIES.
- ALL AREAS OF DISTURBANCE TO BE SEEDED. EXTENTS SHOWN ARE APPROXIMATE ONLY.

PLANT SCHEDULE

| SYMBOL | CODE | BOTANICAL / COMMON NAME | TYPE | SIZE | REMARKS |
|----------------|------|---|--------|----------|--|
| TREES | | | | | |
| | PC | Picea pungens / Colorado Spruce | B & B | 1.0m Ht. | Mature Spread: 7.0 M; Spacing: 5.0 M |
| | PG | Picea pungens 'Glauca' / Blue Colorado Spruce | B & B | 1.0m Ht. | Mature Spread: 6.0 M; Spacing: 5.0 M |
| | PS | Pinus sylvestris / Scotch Pine | B & B | 1.0m Ht. | Mature Spread: 10.0 M; Spacing: 5.0 M |
| | SI | Syringa reticulata 'Ivory Silk' / Ivory Silk Japanese Tree Lilac | B & B | 40mm Cal | Mature Spread: 6.0 M; Spacing: 3.0 M |
| | TD | Tilia x flavescens 'Dropmore' / Dropmore Linden | B & B | 40mm Cal | Mature Spread: 8.0 M; Spacing: 4.0 M |
| SHRUBS | | | | | |
| | Ca | Cornus alba 'Ivory Halo' / Ivory Halo Dogwood | GALLON | #5 | Mature Spread: 2.0 M; Spacing: 1.5 M |
| | Pp | Pinus mugo pumilio / Dwarf Mugo Pine | GALLON | #5 | Mature Spread: 1.5 M; Spacing: 1.2 M |
| | Pa | Potentilla fruticosa 'Abbotswood' / Abbotswood Bush Cinquefoil | GALLON | #5 | Mature Spread: 1.0 M; Spacing: 0.75 M |
| | Sa | Symphoricarpos albus / Common White Snowberry | GALLON | #5 | Mature Spread: 1.0 M; Spacing: 0.75 M |
| GRASSES | | | | | |
| | CI | Calamagrostis x acutiflora 'Karl Foerster' / Karl Foerster Reed Grass | GALLON | #1 | Mature Spread: 0.75 M; Spacing: 0.60 M |

GROUND COVERS

| SYMBOL | DESCRIPTION | CONT | SIZE | REMARKS |
|--------|--|------|------|-----------------------------------|
| | ng Native Ground Cover (Salvaged & Reused) | | sod | |
| | se Seed Mix | | seed | Complete with 150mm depth topsoil |
| | sd Sod Mix | | sod | Complete with 130mm depth topsoil |

MATERIALS SCHEDULE

| SYMBOL | DESCRIPTION |
|--------|--------------------------------------|
| | PLANTING BED - TOPSOIL (600mm DEPTH) |
| | GRAVEL PAVING |

01 LANDSCAPE PLAN
90103 SCALE: 1:1000



PRELIMINARY
NOT FOR DESIGN OR CONSTRUCTION

100% COMPLETE
XX

CONFIDENTIAL

This Engineering document and all information herein are the property of USG Corporation or one of its subsidiaries ("USGC") and are CONFIDENTIAL. They are to be used only in connection with the work you are doing on behalf of USGC. Their disclosure to a third party or non-employee may only be made under an appropriate confidentiality agreement with the prior written permission of USGC or its authorized representative.



| REVISIONS | REVISIONS | REVISIONS | CONTROL NUMBER | 0 1 2 3 4 5 | DRAWN BY: | COPYRIGHT NOTICE | | DRAWING NUMBER |
|--|-----------------|-----------------|----------------|---------------|------------|---|--|-----------------------------------|
| | | | | 6 7 8 9 10 11 | NL | UNITED STATES | CGC ARCHITECTURE 49 WSP PROJECT NO. 47092 211-11100-00 | DRAWING NUMBER WAB90103 |
| | | | | | RM | CYPRUS | | |
| | | | | | RM | COMPANY @ 2023 | PLANT - WHEATLAND ADDRESS - 262033 TWP RD 222, WHEATLAND, ALBERTA | |
| B FEB. 2024 ISSUED FOR DEVELOPMENT PERMIT REVIEW | | | | | | THIS DRAWING IN DESIGN AND DETAILS IS THE PROPERTY OF THE USGC CORPORATION AND MUST NOT BE USED EXCEPT IN CONNECTION WITH OUR WORK. ALL RIGHTS OF DESIGN OR INVENTION ARE RESERVED. | | |
| A JAN. 2024 ISSUED FOR CLIENT REVIEW | | | | | | LANDSCAPE PLAN | | REV. B |
| NO. DATE ISSUED | NO. DATE ISSUED | NO. DATE ISSUED | | | ISSUED BY: | | | PRINT DATE: |

Do Not Scale Drawing
Right is Reserved to Make
Changes at Our Option

SCALE: 1:1000

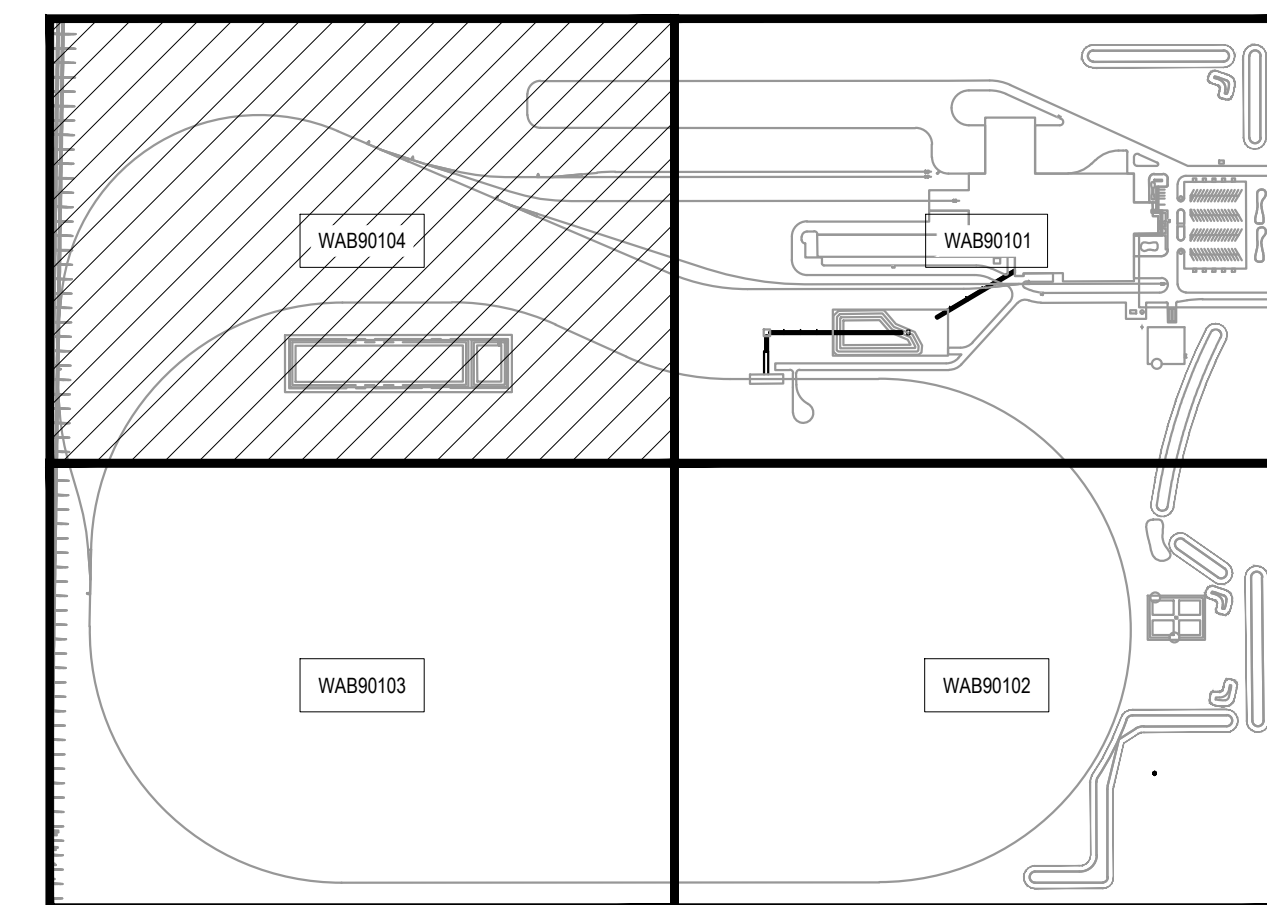
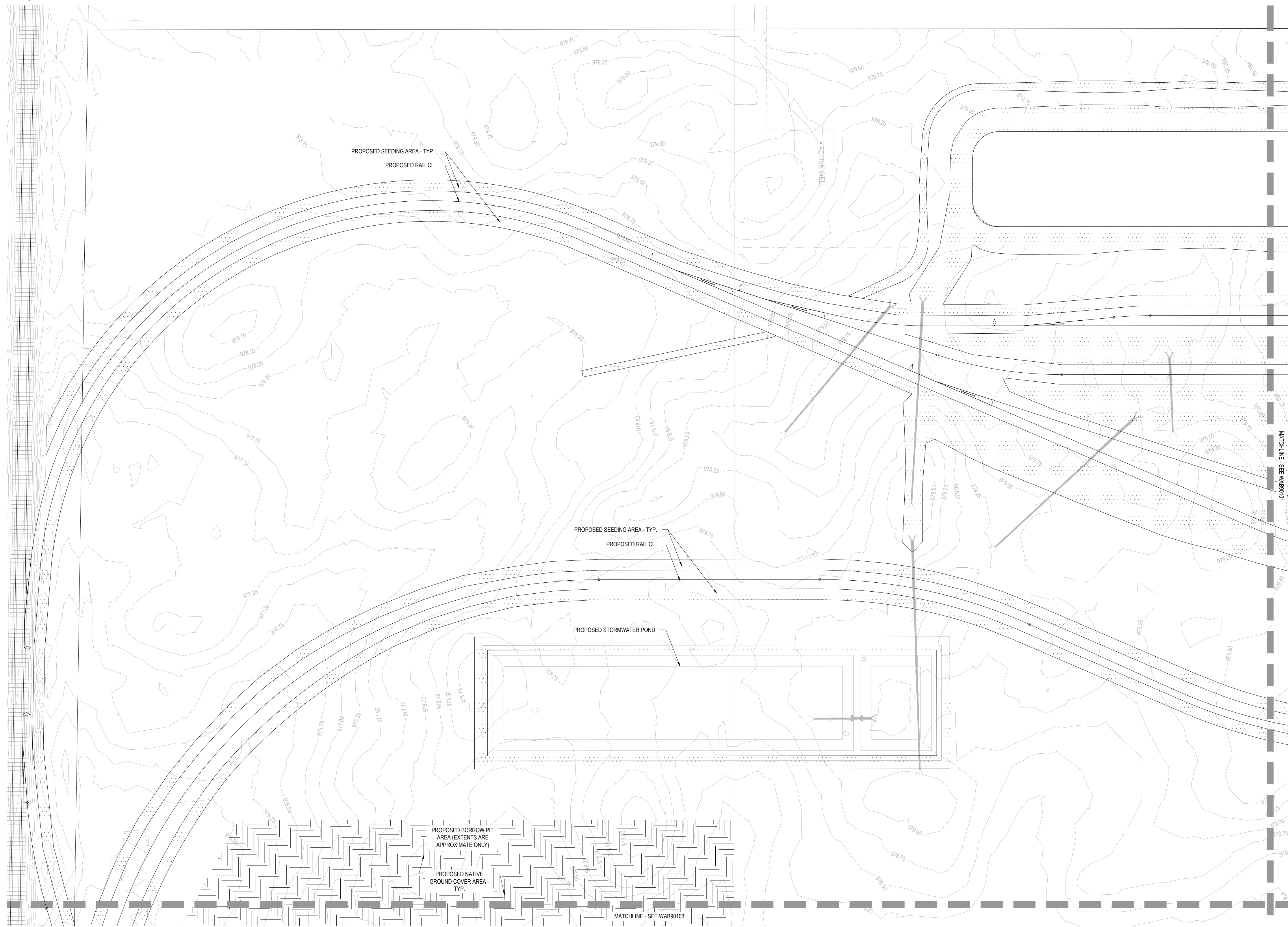
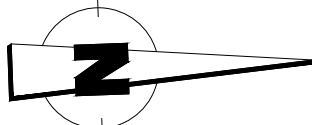

02 KEY PLAN
90104 SCALE: 1:7000

LEGEND

| | |
|--|---|
| | MATCHLINE |
| | EXISTING GROUND CONTOURS (0.25m INTERVAL) |
| | EXISTING RAIL CL |
| | PROPOSED RAIL CL |
| | EXISTING GAS LINE |
| | PROPOSED GAS LINE |
| | EXISTING OVERHEAD POWER LINE |
| | PROPOSED UNDERGROUND POWER SERVICE |
| | EXISTING UNDERGROUND COMMUNICATION LINE |
| | PROPOSED UNDERGROUND COMMUNICATION LINE |
| | PROPOSED WATER LINE |
| | EXISTING CULVERT |
| | EXISTING FENCE |
| | PROPOSED FENCE |
| | EXISTING POWER POLE |
| | EXISTING COMMUNICATION PEDESTAL |
| | PROPOSED TOE OF BERM |

NOTES

- COORDINATE SYSTEM IS UTM 12N REFERENCE TO ASCM 387521.
- ALL DIMENSIONS ARE IN METERS UNLESS OTHERWISE NOTED.
- CONFIRM INVERTS OF ALL EXISTING UTILITIES. NOTIFY LANDSCAPE ARCHITECT OF ANY DISCREPANCIES.
- ALL AREAS OF DISTURBANCE TO BE SEEDED. EXTENTS SHOWN ARE APPROXIMATE ONLY.

PLANT SCHEDULE

| SYMBOL | CODE | BOTANICAL / COMMON NAME | TYPE | SIZE | REMARKS |
|--------------|------|--|-------|----------|---------------------------------------|
| TREES | | | | | |
| | PC | Picea pungens / Colorado Spruce | B & B | 1.0m Ht. | Mature Spread: 7.0 M; Spacing: 5.0 M |
| | PG | Picea pungens 'Glauca' / Blue Colorado Spruce | B & B | 1.0m Ht. | Mature Spread: 6.0 M; Spacing: 5.0 M |
| | PS | Pinus sylvestris / Scotch Pine | B & B | 1.0m Ht. | Mature Spread: 10.0 M; Spacing: 5.0 M |
| | SI | Syringa reticulata 'Ivory Silk' / Ivory Silk Japanese Tree Lilac | B & B | 40mm Cal | Mature Spread: 6.0 M; Spacing: 3.0 M |
| | TD | Tilia x flavescens 'Dropmore' / Dropmore Linden | B & B | 40mm Cal | Mature Spread: 8.0 M; Spacing: 4.0 M |

| SYMBOL | CODE | BOTANICAL / COMMON NAME | CONT | SIZE | REMARKS |
|---------------|------|--|--------|------|---------------------------------------|
| SHRUBS | | | | | |
| | Ca | Cornus alba 'Ivory Halo' / Ivory Halo Dogwood | GALLON | #5 | Mature Spread: 2.0 M; Spacing: 1.5 M |
| | Pp | Pinus mugo pumilio / Dwarf Mugo Pine | GALLON | #5 | Mature Spread: 1.5 M; Spacing: 1.2 M |
| | Pa | Potentilla fruticosa 'Abbotswood' / Abbotswood Bush Cinquefoil | GALLON | #5 | Mature Spread: 1.0 M; Spacing: 0.75 M |
| | Sa | Symphoricarpos albus / Common White Snowberry | GALLON | #5 | Mature Spread: 1.0 M; Spacing: 0.75 M |

| SYMBOL | CODE | BOTANICAL / COMMON NAME | CONT | SIZE | REMARKS |
|----------------|------|---|--------|------|--|
| GRASSES | | | | | |
| | Ci | Calamagrostis x acutiflora 'Karl Foerster' / Karl Foerster Reed Grass | GALLON | #1 | Mature Spread: 0.75 M; Spacing: 0.60 M |

GROUND COVERS

| SYMBOL | CODE | DESCRIPTION | CONT | REMARKS |
|--------|------|---|------|-----------------------------------|
| | ng | Native Ground Cover (Salvaged & Reused) | sod | |
| | se | Seed Mix | seed | Complete with 150mm depth topsoil |
| | sd | Sod Mix | sod | Complete with 130mm depth topsoil |

MATERIALS SCHEDULE

| SYMBOL | DESCRIPTION |
|--------|--------------------------------------|
| | PLANTING BED - TOPSOIL (600mm DEPTH) |
| | GRAVEL PAVING |

01 LANDSCAPE PLAN
90104 SCALE: 1:1000

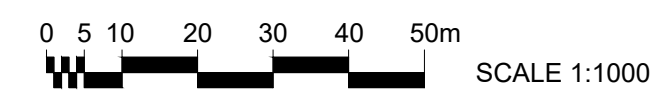

PRELIMINARY
NOT FOR DESIGN OR CONSTRUCTION

100% COMPLETE
XX

CONFIDENTIAL

This Engineering document and all information herein are the property of USG Corporation or one of its subsidiaries ("USGC") and are CONFIDENTIAL. They are to be used only in connection with the work you are doing on behalf of USGC. Their disclosure to a third party or non-employee may only be made under an appropriate confidentiality agreement with the prior written permission of USGC or its authorized representative.



| REVISIONS | REVISIONS | REVISIONS | CONTROL NUMBER |
|--|-----------------|-----------------|----------------|
| NO. DATE ISSUED | NO. DATE ISSUED | NO. DATE ISSUED | |
| B FEB. 2024 ISSUED FOR DEVELOPMENT PERMIT REVIEW | | | |
| A JAN. 2024 ISSUED FOR CLIENT REVIEW | | | |

| | |
|---------------|-----------------|
| 0 1 2 3 4 5 | DRAWN BY: NL |
| 6 7 8 9 10 11 | CHECKED BY: RM |
| | APPROVED BY: RM |
| | ISSUED BY: |

01 LANDSCAPE PLAN
90104 SCALE: 1:1000

Do Not Scale Drawing
Right is Reserved to Make
Changes at Our Option

ISSUED BY:

SCALE: 1:1000

PRINTING DATE:

DRAWING NUMBER
WAB90104

REV. B

LANDSCAPE PLAN

CGC ARCHITECTURE 49
USG PROJECT NO. 47092
WSP PROJECT NO. 211-11100-00
PLANT - WHEATLAND
ADDRESS - 262033 TWP RD 222, WHEATLAND, ALBERTA

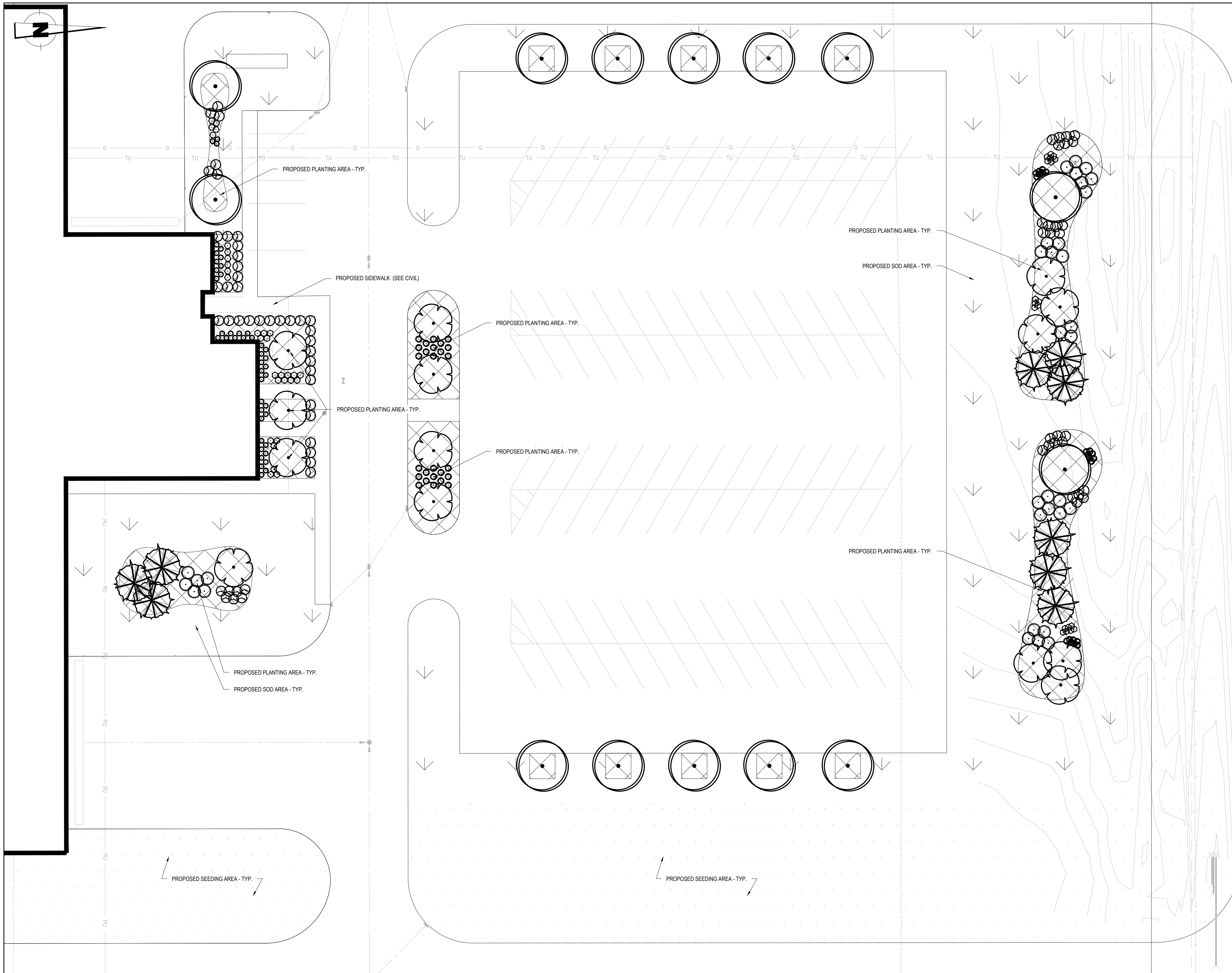

LEGEND

| | |
|--|---|
| | EXISTING GROUND CONTOURS (0.25m INTERVAL) |
| | EXISTING RAIL CL |
| | PROPOSED RAIL CL |
| | EXISTING GAS LINE |
| | PROPOSED GAS LINE |
| | EXISTING OVERHEAD POWER LINE |
| | PROPOSED UNDERGROUND POWER SERVICE |
| | EXISTING UNDERGROUND COMMUNICATION LINE |
| | PROPOSED UNDERGROUND COMMUNICATION LINE |
| | PROPOSED WATER LINE |
| | EXISTING CULVERT |
| | EXISTING FENCE |
| | PROPOSED FENCE |
| | EXISTING POWER POLE |
| | EXISTING COMMUNICATION PEDESTAL |

- NOTES**
- COORDINATE SYSTEM IS UTM 12N REFERENCE TO ASCM 397521
 - ALL DIMENSIONS ARE IN METERS UNLESS OTHERWISE NOTED.
 - CONFIRM INVERTS OF ALL EXISTING UTILITIES, NOTIFY LANDSCAPE ARCHITECT OF ANY DISCREPANCIES.
 - ALL AREAS OF DISTURBANCE TO BE SEEDDED, EXTENTS SHOWN ARE APPROXIMATE ONLY.

PLANT SCHEDULE

| SYMBOL | CODE | BOTANICAL / COMMON NAME | TYPE | SIZE | REMARKS |
|----------------------|------|---|--------|----------|--|
| TREES | | | | | |
| | PC | Picea pungens / Colorado Spruce | B & B | 1.0m Ht. | Mature Spread: 7.0 M; Spacing: 5.0 M |
| | PG | Picea pungens 'Glauca' / Blue Colorado Spruce | B & B | 1.0m Ht. | Mature Spread: 6.0 M; Spacing: 5.0 M |
| | PS | Pinus sylvestris / Scotch Pine | B & B | 1.0m Ht. | Mature Spread: 10.0 M; Spacing: 5.0 M |
| | SI | Syringa reticulata 'Ivory Silk' / Ivory Silk Japanese Tree Lilac | B & B | 40mm Cal | Mature Spread: 6.0 M; Spacing: 3.0 M |
| | TD | Tilia x flavescens 'Dropmore' / Dropmore Linden | B & B | 40mm Cal | Mature Spread: 8.0 M; Spacing: 4.0 M |
| SHRUBS | | | | | |
| | Ca | Cornus alba 'Ivory Halo' / Ivory Halo Dogwood | GALLON | #5 | Mature Spread: 2.0 M; Spacing: 1.5 M |
| | Pp | Pinus mugo pumilio / Dwarf Mugo Pine | GALLON | #5 | Mature Spread: 1.5 M; Spacing: 1.2 M |
| | Pa | Potentilla fruticosa 'Abbotswood' / Abbotswood Bush Cinquefoil | GALLON | #5 | Mature Spread: 1.0 M; Spacing: 0.75 M |
| | Sa | Symphoricarpos albus / Common White Snowberry | GALLON | #5 | Mature Spread: 1.0 M; Spacing: 0.75 M |
| GRASSES | | | | | |
| | Ci | Calamagrostis x acutiflora 'Karl Foerster' / Karl Foerster Reed Grass | GALLON | #1 | Mature Spread: 0.75 M; Spacing: 0.60 M |
| GROUND COVERS | | | | | |
| | ng | Native Ground Cover (Salvaged & Reused) | sod | | |
| | se | Seed Mix | seed | | Complete with 150mm depth topsoil |
| | sd | Sod Mix | sod | | Complete with 130mm depth topsoil |

MATERIALS SCHEDULE

| SYMBOL | DESCRIPTION |
|--------|--------------------------------------|
| | PLANTING BED - TOPSOIL (600mm DEPTH) |
| | GRAVEL PAVING |

01 LANDSCAPE ENLARGEMENT - PARKING LOT & BUILDING
 90105 SCALE: 1:250



PRELIMINARY
 NOT FOR DESIGN OR CONSTRUCTION

100% COMPLETE
XX

CONFIDENTIAL

This Engineering document and all information herein are the property of USG Corporation or one of its subsidiaries ("USGC") and are CONFIDENTIAL. They are to be used only in connection with the work you are doing on behalf of USGC. Their disclosure to a third party or non-employee may only be made under an appropriate confidentiality agreement with the prior written permission of USGC or its authorized representative.



| REVISIONS | REVISIONS | REVISIONS | CONTROL NUMBER | 0 1 2 3 4 5 | DRAWN BY: | COPYRIGHT NOTICE UNITED STATES GYPSUM COMPANY @ 2023 THIS DRAWING IN DESIGN AND DETAILS IS THE PROPERTY OF THE USG CORPORATION AND MUST NOT BE USED EXCEPT IN CONNECTION WITH OUR WORK. ALL RIGHTS OF DESIGN OR INVENTION ARE RESERVED. | DRAWING NUMBER | |
|--|-----------------|-----------------|----------------|---------------|-----------|---|--|-----------------|
| | | | | 6 7 8 9 10 11 | NL | | CGC ARCHITECTURE 49 USG PROJECT NO. 47092 WSP PROJECT NO. 211-11100-00 PLANT - WHEATLAND ADDRESS - 262033 TWP RD 222, WHEATLAND, ALBERTA | WAB90105 |
| | | | | | RM | | | |
| | | | | | RM | REV. B | | |
| B FEB. 2024 ISSUED FOR DEVELOPMENT PERMIT REVIEW | | | | | | | | |
| A JAN. 2024 ISSUED FOR CLIENT REVIEW | | | | | | | | |
| NO. DATE ISSUED | NO. DATE ISSUED | NO. DATE ISSUED | | | | | | |

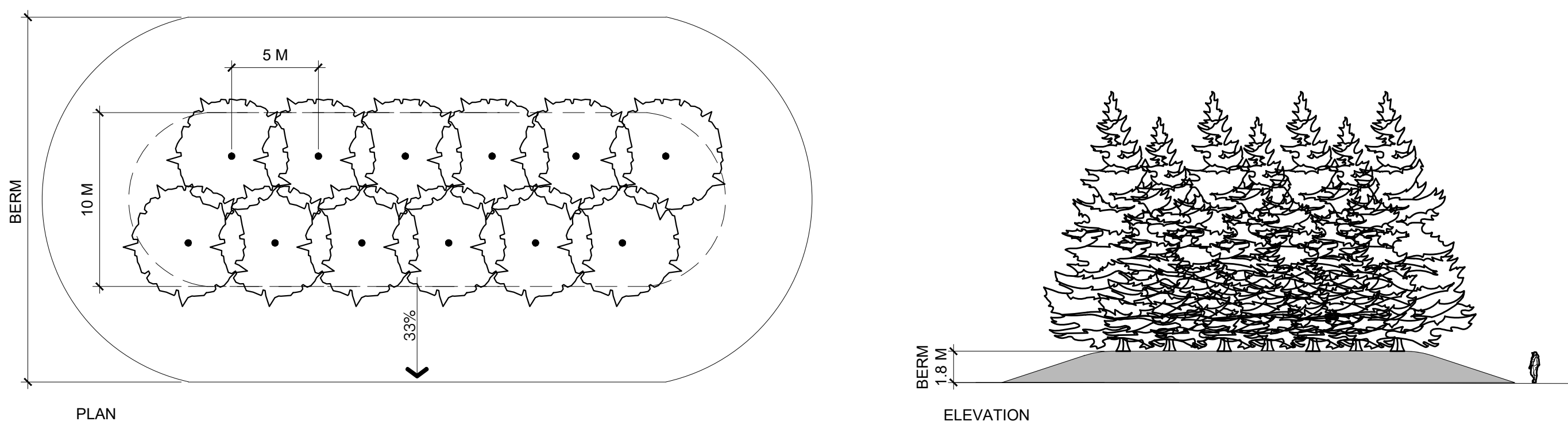

01 TYPICAL FULL SCREENING (TYPE 1) BERM PLANTING
90106 SCALE: 1:250

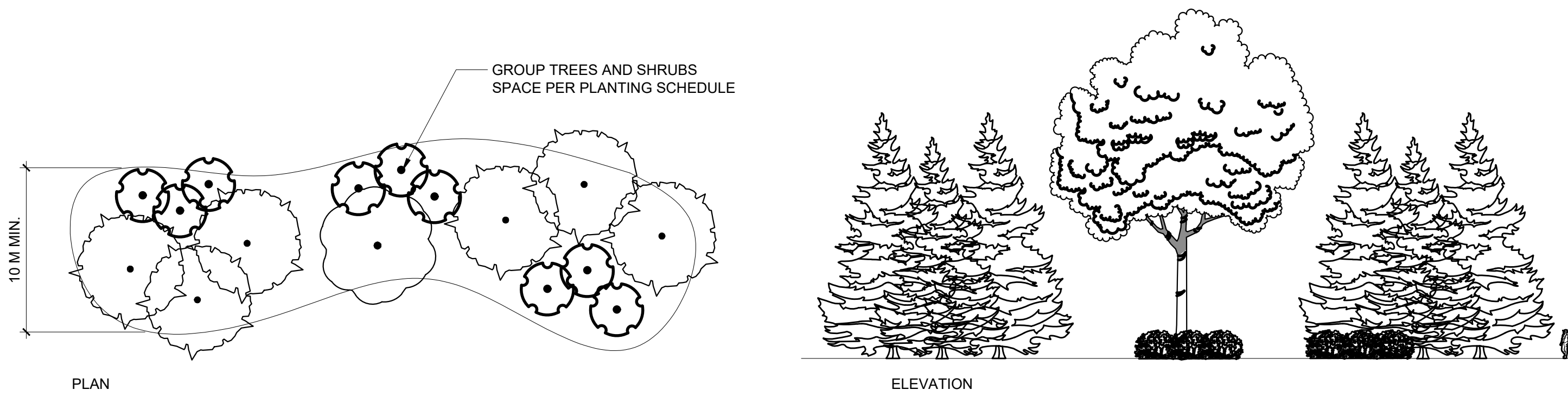

02 TYPICAL PARTIAL SCREENING (TYPE 2) PLANTING
90106 SCALE: 1:250

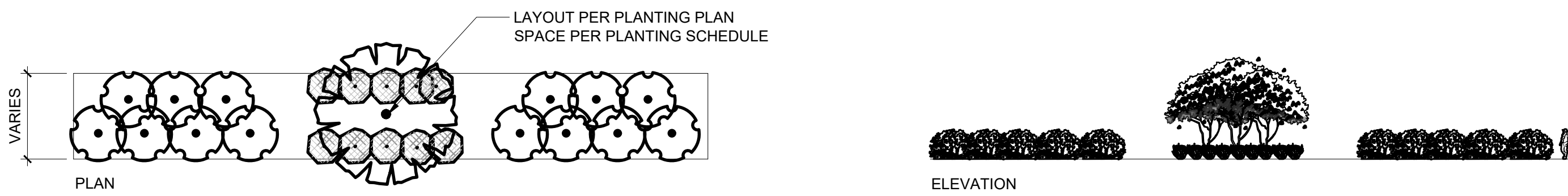

03 TYPICAL BUFFER (TYPE 3) PLANTING
90106 SCALE: 1:250

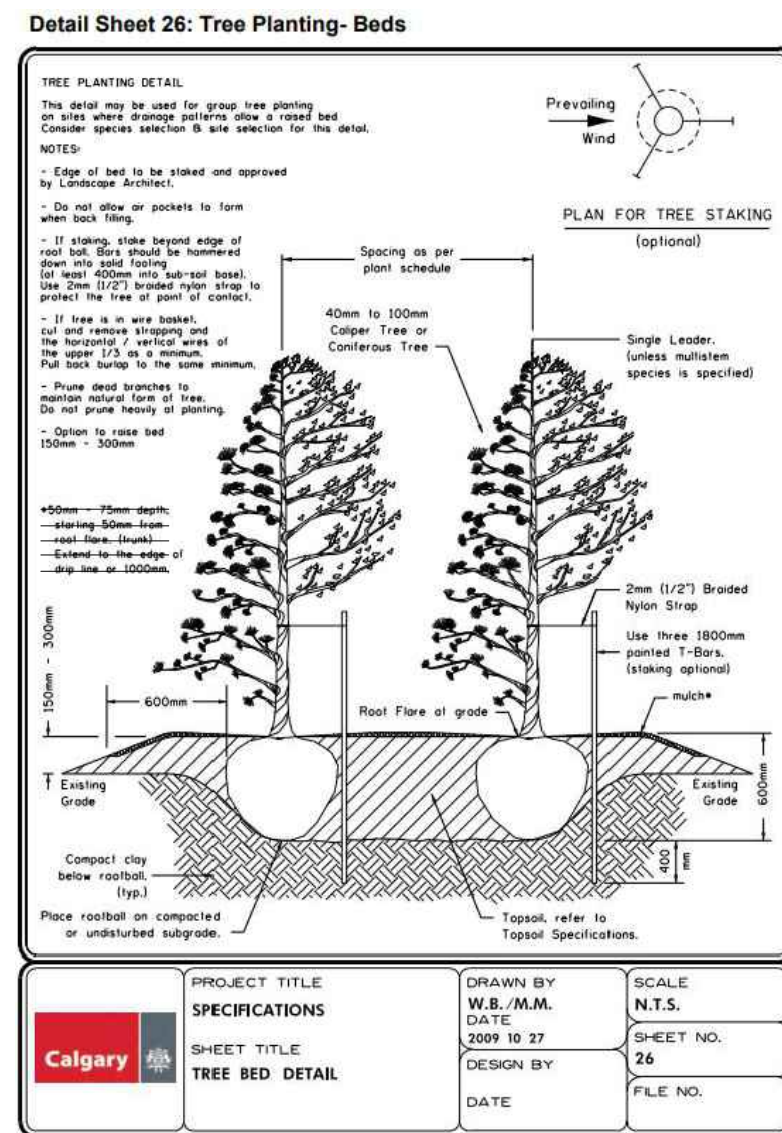

04 TYPICAL TREE BED
90106 SCALE: NTS

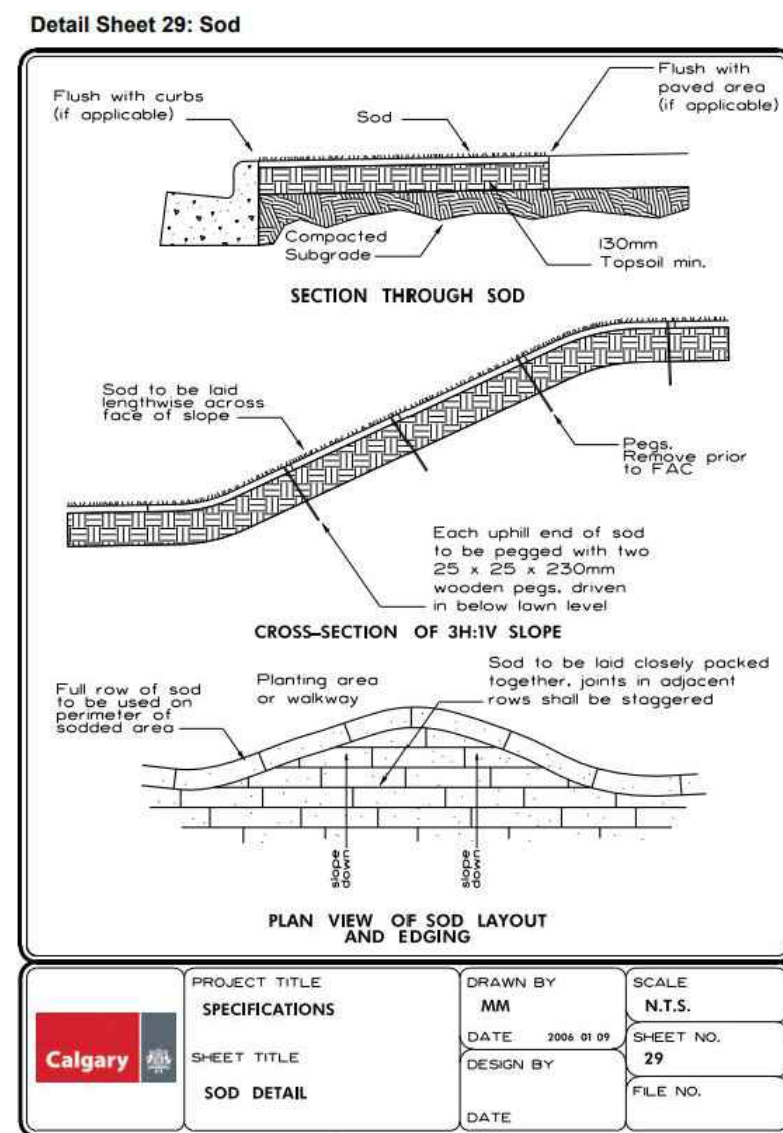

05 TYPICAL SOD DETAIL
90106 SCALE: NTS

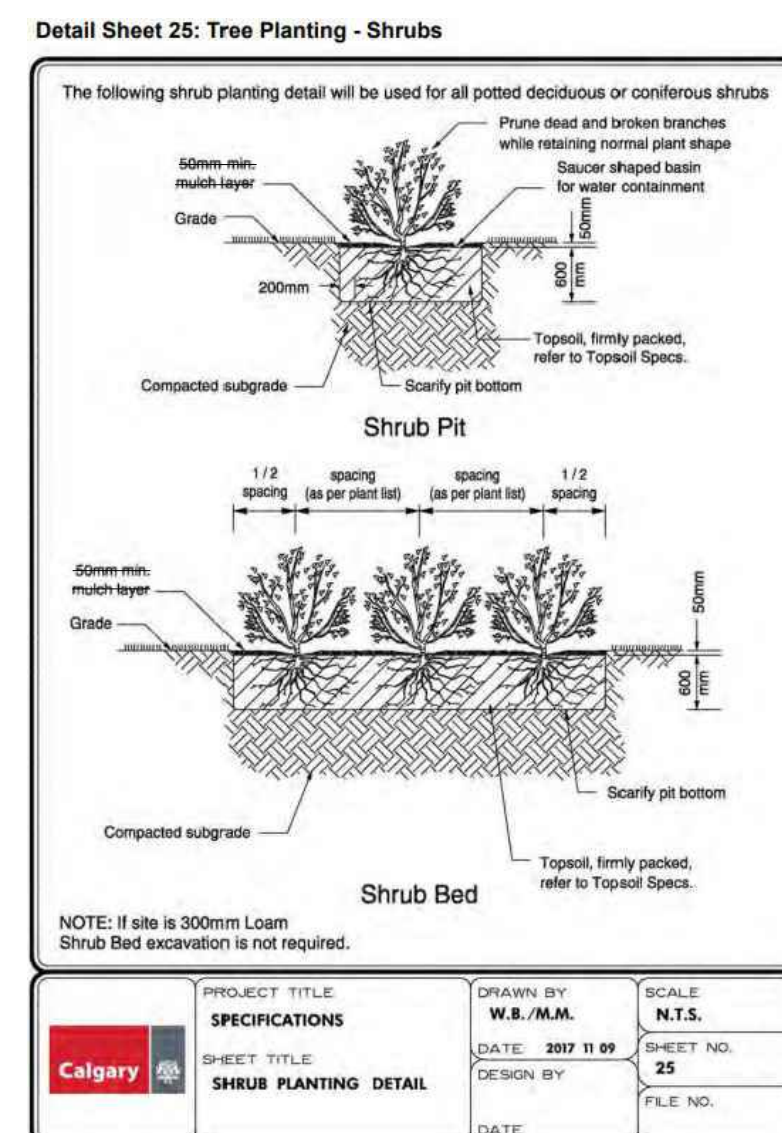

06 TYPICAL SHRUB PLANTING
90106 SCALE: NTS

- GENERAL NOTES:
- ALL WORK SHALL COMPLY WITH THE WHEATLAND COUNTY LANDSCAPE AND SCREENING GUIDELINES.
 - ALL LANDSCAPE CONSTRUCTION MATERIAL AND TECHNIQUES SHALL MEET THE MINIMUM REQUIREMENTS OF THE CANADIAN NURSERY LANDSCAPE ASSOCIATION STANDARDS.
 - CONTRACTOR MUST HAVE A COPY OF THE ACCEPTED PLAN ON SITE AT ALL TIMES TO ENSURE SETBACKS AND VISIBILITY REQUIREMENTS BY WHEATLAND COUNTY.
 - ANY AREAS ADJOINING PROJECT AREA(S) DISTURBED DUE TO CONSTRUCTION TO BE REHABILITATED AND RETURNED TO EXISTING CONDITIONS.
 - CONTRACTOR TO REVIEW DRAWINGS AND REPORT ANY ERRORS, OMISSIONS, AND / OR DISCREPANCIES TO THE PROJECT CONTRACT ADMINISTRATOR IN WRITING PRIOR TO CONSTRUCTION.
 - EXTENT OF WORK SHOWN IS TO CONVEY INTENT ONLY. EXTENT OF CONSTRUCTION IS TO BE VERIFIED ON SITE PRIOR TO CONSTRUCTION. IF THERE IS AMBIGUITY OR LACK OF INFORMATION, THE CONTRACTOR SHALL IMMEDIATELY INFORM THE CONSULTANT'S CONTRACT ADMINISTRATOR. THE CONTRACTOR WILL BE HELD RESPONSIBLE FOR AND PAY FOR REQUIRED REMOVALS RELATED TO ANY CHANGES MADE WITHOUT WRITTEN PERMISSION OF THE PROJECT CONTRACT ADMINISTRATOR.
 - CHANGES TO THE WORK OF THIS CONTRACT THAT ARE UNAUTHORIZED BY THE PROJECT CONTRACT ADMINISTRATOR WILL NOT BE CONSIDERED AS AN EXTRA PAYABLE TO THE CONTRACTOR.
 - ANY AMBIGUITY IN THIS DRAWING OR ACCOMPANYING DETAILS IS TO BE REPORTED TO THE PROJECT CONTRACT ADMINISTRATOR FOR CLARIFICATION. THE CONTRACTOR IS NOT TO PROCEED IN UNCERTAINTY.
 - THE CONTRACTOR SHALL RETAIN AN INDEPENDENT INSPECTION AND TESTING COMPANY, IF REQUIRED TO ENSURE THAT ALL MATERIALS AND WORK IS EXECUTED IN ACCORDANCE WITH THE DRAWINGS.
 - ABSOLUTELY NO STORAGE OF EQUIPMENT OR MATERIALS OUTSIDE OF THE PROJECT CONSTRUCTION SITE IS PERMITTED.

- SIGHTLINES & SETBACKS:
- CONTRACTOR TO CALL ALBERTA ONE-CALL AT 1-800-242-3447 TO HAVE EXISTING UTILITIES LOCATED PRIOR TO START OF ANY CONSTRUCTION. THE CONTRACTOR IS RESPONSIBLE FOR ALL UTILITY LOCATES.
 - CONTRACTOR TO VERIFY LOCATION AND PROTECT ALL SERVICES PRIOR TO ANY EXCAVATION.
 - ALL PLANT MATERIAL MUST BE NURSERY GROWN AND MEET THE SPECIFICATIONS SET OUT IN THE LATEST GUIDE SPECIFICATIONS FOR NURSERY STOCK PREPARED BY THE CANADIAN NURSERY TRADE ASSOCIATION (CNTA) AND THE INTERNATIONAL SOCIETY FOR ARBORICULTURE (ISA) FOR SIZE, HEIGHT, SPREAD, GRADING, QUALITY, AND METHOD OF CULTIVATION.
 - PLANT MATERIAL SHALL BE HEALTHY, AND SHOWING SIGNS OF VIGOROUS GROWTH. ROOT BOUND, DAMAGED, OR DISEASED PLANT MATERIAL SHALL NOT BE ACCEPTED.
 - TOPSOIL: SEE TOPSOIL.
 - ALL LANDSCAPE CONSTRUCTION MATERIALS AND TECHNIQUES SHALL MEET THE MINIMUM REQUIREMENTS OF THE CNLA STANDARDS.
 - NO SUBSTITUTIONS OF PLANT MATERIAL WILL BE PERMITTED BY THE LANDSCAPE CONSULTANT UNLESS APPROVED BY THE LANDSCAPE CONSULTANT IN WRITING PRIOR TO SHIPMENT TO SITE.
 - ALL PLANT MATERIAL SHALL BE INSTALLED AS SHOWN ON THE DRAWINGS AT THE SPACING INDICATED.
 - ANY PLANT MATERIAL INSTALLED THAT DOES NOT MEET WITH THE REQUIREMENTS OF THESE DRAWINGS AND ASSOCIATED SPECIFICATIONS SHALL BE REMOVED AND REPLACED WITH PLANT MATERIAL THAT MEETS THE SPECIFICATIONS AND ASSOCIATED REQUIREMENTS AT THE CONTRACTOR'S SOLE EXPENSE.
 - ALL PLANT MATERIAL SHALL BE APPROVED AT THE SOURCE NURSERY PRIOR TO SHIPMENT TO SITE. THE CONTRACTOR BEARS THE SOLE RESPONSIBILITY OF NOTIFYING THE LANDSCAPE CONSULTANT A MINIMUM OF TWO WEEKS PRIOR TO SHIPMENT OF PLANT MATERIAL TO COORDINATE THE REVIEW OF THE PLANT MATERIAL. THE LANDSCAPE CONSULTANT RESERVES THE RIGHT TO WAIVE THIS REQUIREMENT BASED ON THE NURSERY SOURCE PROPOSED FOR USE BY THE CONTRACTOR.
 - ANY DAMAGE OCCURRING TO THE EXISTING CONSTRUCTION, BUILDINGS, VEGETATION, LANDSCAPING, PATHWAYS AND/OR OTHER SITE AMENITIES ON THE SITE, ADJACENT PRIVATE PROPERTY OR PUBLIC LANDS SHALL BE REHABILITATED, RESTORED AND/OR MADE GOOD, BY THE CONTRACTOR TO THE OWNERS AND/OR THE COUNTY AUTHORITY'S REQUIREMENTS.
 - INSTALLATION:
 - KEEP ALL ROOTS AND ROOT BALLS WATERED PRIOR TO PLANTING.
 - DIG OUT ALL PLANTING EXCAVATIONS BY TREE SPADE, BACKHOE OR HAND SHOVEL.
 - ENSURE WIDTH OF ALL PLANTING EXCAVATIONS IS 450 MM GREATER ON ALL SIDES THAN THE WIDTH OF THE ROOT BALL OR AS PER SITE CONDITIONS TO MAINTAIN VOLUME.
 - SCARIFY SUBGRADE TO A DEPTH OF 75MM UNDER ALL TREE PITS AND SHRUB BEDS.
 - PLACE PLANT PLUMB IN THE CENTRE OF THE PLANTING PIT WITH A FIRM BASE UNDER THE ROOT BALL.
 - FACE THE PLANT TO GIVE THE BEST APPEARANCE OR RELATIONSHIP TO THE ADJACENT STRUCTURES.
 - BACKFILL WITH TOPSOIL AND FIRMLY COMPACT TO ENSURE THE PLANT RETAINS ITS ORIENTATION. ENSURE NO AIR POCKETS REMAIN AROUND THE ROOTS.
 - THOROUGHLY WATER PLANTS WITHIN THE SAME WORKING DAY OF PLANTING.

- BERMS:
- BERMS ARE TO BE THREE (3) HORIZONTAL UNITS ON EACH SIDE FOR EVERY VERTICAL UNIT (3:1).
 - COMPACT EARTH TO 85% STANDARDS PROCTOR DENSITY.
 - TOP OF BERM IS TO BE ROUNDED.

- TOPSOIL:
- TOPSOIL: NATIVE MATERIAL SALVAGED FOR REUSE.
 - DEPTH OF TOPSOIL: AS INDICATED IN SCHEDULES.

- PLANTING:
- PLANTING MATERIAL:
 - TREES, SHRUBS, AND DECORATIVE GRASSES OF SPECIES, QUANTITIES, AND SIZES INDICATED IN THE PLANTING SCHEDULE.
 - MINIMUM SIZE FOR CONIFEROUS TREES IS 1 M HEIGHT, 600 MM ROOT BALL DIAMETER.
 - MINIMUM #5 POT FOR ALL SHRUBS.
 - MINIMUM 40 MM CALIPER FOR DECIDUOUS TREES, 600 MM ROOT BALL DIAMETER.
 - ALL PLANT MATERIAL MUST BE NURSERY GROWN AND MEET THE SPECIFICATIONS SET OUT IN THE LATEST GUIDE SPECIFICATIONS FOR NURSERY STOCK PREPARED BY THE CANADIAN NURSERY TRADE ASSOCIATION (CNTA) AND THE INTERNATIONAL SOCIETY FOR ARBORICULTURE (ISA) FOR SIZE, HEIGHT, SPREAD, GRADING, QUALITY, AND METHOD OF CULTIVATION.
 - PLANT MATERIAL SHALL BE HEALTHY, AND SHOWING SIGNS OF VIGOROUS GROWTH. ROOT BOUND, DAMAGED, OR DISEASED PLANT MATERIAL SHALL NOT BE ACCEPTED.
 - TOPSOIL: SEE TOPSOIL.
 - ALL LANDSCAPE CONSTRUCTION MATERIALS AND TECHNIQUES SHALL MEET THE MINIMUM REQUIREMENTS OF THE CNLA STANDARDS.
 - NO SUBSTITUTIONS OF PLANT MATERIAL WILL BE PERMITTED BY THE LANDSCAPE CONSULTANT UNLESS APPROVED BY THE LANDSCAPE CONSULTANT IN WRITING PRIOR TO SHIPMENT TO SITE.
 - ALL PLANT MATERIAL SHALL BE INSTALLED AS SHOWN ON THE DRAWINGS AT THE SPACING INDICATED.
 - ANY PLANT MATERIAL INSTALLED THAT DOES NOT MEET WITH THE REQUIREMENTS OF THESE DRAWINGS AND ASSOCIATED SPECIFICATIONS SHALL BE REMOVED AND REPLACED WITH PLANT MATERIAL THAT MEETS THE SPECIFICATIONS AND ASSOCIATED REQUIREMENTS AT THE CONTRACTOR'S SOLE EXPENSE.
 - ALL PLANT MATERIAL SHALL BE APPROVED AT THE SOURCE NURSERY PRIOR TO SHIPMENT TO SITE. THE CONTRACTOR BEARS THE SOLE RESPONSIBILITY OF NOTIFYING THE LANDSCAPE CONSULTANT A MINIMUM OF TWO WEEKS PRIOR TO SHIPMENT OF PLANT MATERIAL TO COORDINATE THE REVIEW OF THE PLANT MATERIAL. THE LANDSCAPE CONSULTANT RESERVES THE RIGHT TO WAIVE THIS REQUIREMENT BASED ON THE NURSERY SOURCE PROPOSED FOR USE BY THE CONTRACTOR.
 - ANY DAMAGE OCCURRING TO THE EXISTING CONSTRUCTION, BUILDINGS, VEGETATION, LANDSCAPING, PATHWAYS AND/OR OTHER SITE AMENITIES ON THE SITE, ADJACENT PRIVATE PROPERTY OR PUBLIC LANDS SHALL BE REHABILITATED, RESTORED AND/OR MADE GOOD, BY THE CONTRACTOR TO THE OWNERS AND/OR THE COUNTY AUTHORITY'S REQUIREMENTS.
 - INSTALLATION:
 - KEEP ALL ROOTS AND ROOT BALLS WATERED PRIOR TO PLANTING.
 - DIG OUT ALL PLANTING EXCAVATIONS BY TREE SPADE, BACKHOE OR HAND SHOVEL.
 - ENSURE WIDTH OF ALL PLANTING EXCAVATIONS IS 450 MM GREATER ON ALL SIDES THAN THE WIDTH OF THE ROOT BALL OR AS PER SITE CONDITIONS TO MAINTAIN VOLUME.
 - SCARIFY SUBGRADE TO A DEPTH OF 75MM UNDER ALL TREE PITS AND SHRUB BEDS.
 - PLACE PLANT PLUMB IN THE CENTRE OF THE PLANTING PIT WITH A FIRM BASE UNDER THE ROOT BALL.
 - FACE THE PLANT TO GIVE THE BEST APPEARANCE OR RELATIONSHIP TO THE ADJACENT STRUCTURES.
 - BACKFILL WITH TOPSOIL AND FIRMLY COMPACT TO ENSURE THE PLANT RETAINS ITS ORIENTATION. ENSURE NO AIR POCKETS REMAIN AROUND THE ROOTS.
 - THOROUGHLY WATER PLANTS WITHIN THE SAME WORKING DAY OF PLANTING.

- SEEDING:
- SEED MIX:
 - CITY OF CALGARY "URBAN A" GRASS MIX:
 - KENTUCKY BLUE GRASS (DROUGHT TOLERANT CULTIVARS) - 20%
 - FINE FESCUE BLEND (CREEPING, CHEWING, HARD) - 65%
 - PERENNIAL RYE GRASS - 15%
 - HYDROMULCH:
 - WOOD FIBER MULCH.
 - SEEDING RATE:
 - 30 KG/HA IF MECHANICALLY (BRILLION) SEEDED.
 - 40-45 KG/HA IF HAND BROADCAST.
 - 50-60 KG/HA IF HYDROSEEDED.
 - ALL SEED MUST BE FROM A RECOGNIZED SEED SUPPLIER, MEETING THE REQUIREMENTS FOR THE SEEDS ACT FOR CANADA #1 SEED GRADE.
 - SEED MIXES USED ARE TO BE FREE OF NOXIOUS AND PROHIBITED NOXIOUS WEEDS, PER THE ALBERTA WEED ACT.
 - SEED TO BE APPROVED BY CONSULTANT PRIOR TO DELIVERY TO SITE.
 - SEED TO BE DELIVERED IN THE ORIGINAL CONTAINERS, AND TAGGED WITH SEED IDENTIFICATION TAGS.

- SOD:
- SOD MIX: SOD TO BE FREEDOM FESCUE SOD BY EAGLE LAKE OR APPROVED EQUAL.
 - CERTIFIED NO. 1 CULTIVATED TURF SOD WITH STRONG FIBROUS ROOT SYSTEM, THICK AND HEALTHY GROWTH AND DELIVERED 24 HOURS FROM THE TIME OF CUTTING.
 - SOD SHOWING SIGNS OF DETERIORATION DUE TO AGE OR LACK OF MOISTURE WILL BE REJECTED.
 - SOD MUST BE FREE OF STONES, BURNS, DRY OR BARE SPOTS, TEARS AND DELIVERED MOIST, CUT IN STRIPS OF UNIFORM WIDTH AND THICKNESS.

- INSTALLATION:
- TOPSOIL SHALL BE EVENLY SPREAD OVER SUB-GRADE AND LOOSELY COMPACTED FOR SODDED AREAS.
 - ALL STONES AND DEBRIS OVER 25MM DIA. SHALL BE REMOVED. ALL TOPSOIL SHALL BE VIRTUALLY FREE OF PLANTS OR THEIR ROOTS, BUILDING MATERIALS, INVASIVE OR NOXIOUS PLANTS AND THEIR REPRODUCTIVE PARTS, NON-COMPOSTED WOOD, INSECTS PESTS, CHEMICAL POLLUTANTS OR SUBSTANCES AT LEVELS TOXIC TO PLANTS.
 - SOIL SHALL HAVE AN ACIDITY RANGE OF PH 6.0 - 7.5 AND CONTAIN NO LESS THAN 5% ORGANIC MATTER.
 - SOD SHALL BE PLACED WITH STAGGERED BUTT JOINTS, WATERED THOROUGHLY, AND ROLLED WHEN DRY.
 - LAY SOD SECTIONS PERPENDICULAR ON SLOPES GREATER THAN 3:1 AND SECURE WITH STAKES OR PINS. PLACE STAKES 3 PER SQUARE METER, 100MM BELOW TOP EDGE TO PREVENT SHIFTING OF SOD AND DRIVE PEGS FLUSH WITH TOP OF SOD SOIL. PROVIDE A MINIMUM OF 2 STAKES PER ROLL OF SOD.
- MAINTENANCE:
- MAINTAIN SODDED AREAS IMMEDIATELY FOLLOWING INSTALLATION UNTIL ISSUANCE OF FINAL ACCEPTANCE BY WHEATLAND COUNTY.
 - MAINTENANCE SHALL INCLUDE ALL NECESSARY MEASURES TO ESTABLISH AND MAINTAIN GRASS IN A HEALTHY, VIGOROUS GROWING CONDITION.
 - TURF GRASS MAINTENANCE SHALL INCLUDE, BUT NOT BE LIMITED TO THE FOLLOWING WORK:
 - a. MOWING(S) TO MAINTAIN A MAXIMUM HEIGHT OF 60MM. DO NOT CUT MORE THAN 1/3 OF THE GRASS HEIGHT AT ANY ONE MOWING. TRIM AND CLIP EDGES. REMOVE CLIPPINGS AFTER MOWING AND TRIMMING.
 - b. WATERING WHEN REQUIRED IN SUFFICIENT QUANTITIES AND AT A FREQUENCY TO MAINTAIN HEALTHY GRASS.
 - c. FERTILIZE SODDED AREAS ONE MONTH AFTER SODDING WITH 2:1:1 RATIO FERTILIZER. SPREAD EVENLY AT A RATE AS PER MANUFACTURER'S INSTRUCTIONS AND WATER IN WELL.

- NATIVE GROUND COVER:
- NATIVE GROUND COVER SALVAGED TO A DEPTH OF 100MM AS PART OF SITE PREPARATION.
 - SALVAGED MATERIAL TO BE PLACED WITHIN THE AREA OF DISTURBANCE AS INDICATED ON THE LANDSCAPE PLAN FOLLOWING COMPLETION OF WORK.

- GRAVEL PAVING:
- 100MM DEPTH OF 25MM DIAMETER CRUSHED GRAVEL COMPACTED TO 98%.
 - PLACED UPON A PREPARED SUBGRADE.

- IRRIGATION:
- AUTOMATED IRRIGATION SYSTEM TO BE EMPLOYED TO WATER THE FRONT ENTRY PLANTING AREAS.
 - A LOW-FLOW DRIP LINES TO BE EMPLOYED TO WATER THE BERM PLANTINGS.

- MAINTENANCE:
- ALL PLANTS, SEED, AND SOD, SHALL BE MAINTAINED IN HEALTHY CONDITION DURING THE DEFINED WARRANTY PERIOD.
 - CONTRACTOR SHALL BE RESPONSIBLE FOR MAINTAINING THE HEALTH OF THE PLANTING MATERIAL.
 - MAINTENANCE TO INCLUDE: WATERING (PER IRRIGATION), WEEDING, AND PLANT REPLACEMENTS.

- PLANT MATERIAL WARRANTY:
- THE CONTRACTOR HEREBY WARRANTS THE WORK OF THIS SECTION FOR A FULL ONE (1) YEAR FROM THE RECOGNIZED COMPLETION DATE TO THE ENTIRE PROJECT. REQUIRED REPLACEMENTS SHALL BE PLANTS OF THE SAME SPECIES AND SIZE AS ORIGINALLY SPECIFIED, AND SHALL BE SUPPLIED AND PLANTED IN ACCORDANCE WITH THE DRAWINGS AND SPECIFICATIONS. SUCH REPLACEMENT MATERIAL SHALL ALSO BE SUBJECT TO A FULL ONE-YEAR WARRANTY PERIOD.

PRELIMINARY
NOT FOR DESIGN OR CONSTRUCTION

CONFIDENTIAL

This Engineering document and all information herein are the property of USG Corporation or one of its subsidiaries ("USGC") and are CONFIDENTIAL. They are to be used only in connection with the work you are doing on behalf of USGC. Their disclosure to a third party or non-employee may only be made under an appropriate confidentiality agreement with the prior written permission of USGC or its authorized representative.



| REVISIONS | REVISIONS | REVISIONS | CONTROL NUMBER | 0 | 1 | 2 | 3 | 4 | 5 | DRAWN BY: | NL | COPYRIGHT NOTICE | DRAWING NUMBER |
|-----------|-----------|-----------|----------------|---|---|---|---|----|----|--------------|----|---|----------------|
| | | | | 6 | 7 | 8 | 9 | 10 | 11 | CHECKED BY: | RM | UNITED STATES | WAB90106 |
| | | | | | | | | | | APPROVED BY: | RM | CYPSULM | |
| | | | | | | | | | | | | COMPANY @ 2023 | |
| | | | | | | | | | | | | USG PROJECT NO. 47092 | |
| | | | | | | | | | | | | WSP PROJECT NO. 211-11100-00 | |
| | | | | | | | | | | | | PLANT - WHEATLAND | |
| | | | | | | | | | | | | ADDRESS - 262033 TWP RD 222, WHEATLAND, ALBERTA | |
| | | | | | | | | | | | | LANDSCAPE DETAILS | |
| | | | | | | | | | | | | | REV. B |