



**WHEATLAND**  
COUNTY

APRIL 2022

**CONNECTOR**





# GOOD FOOD BOX

## Fresh Produce at a fraction of the Cost!

The Good Food Box program was established to encourage healthy eating while making it affordable for individuals and families alike. The program has been in our area since the fall of 2014 and offers fresh fruits and vegetables to its clients.

The program is available to anyone who is interested in taking part; no restrictions to numbers of boxes purchased or eligibility of participants.



### Boxes can be purchased in three different sizes:

SMALL which offers 25-30 pounds of food= \$27  
MEDIUM which offers 35-40 pounds of food= \$32  
LARGE which offers 45-50 pounds of food= \$37

*\*There is a \$2 handling/shipping fee which is also added to the initial cost.*

Each box contains the basic produce staples: potatoes, carrots, onions, apples and oranges with additional seasonal fruits and vegetables rounding out the weight.

The program is made possible because the Community Kitchens Program of Calgary (with whom we partner) bypasses the retailers and goes directly to importers and produce handlers in the province.

For additional information or to order your box, please call Wheatland FCSS at  
Ph: 403-934-5335  
or email: [info@wfcss.org](mailto:info@wfcss.org)

Participants pre-order, pay and pick up their boxes at Wheatland FCSS, Wheatland Administrative Office at the corner of Range Road 243 and Highway 1.

### Upcoming 2022 order and delivery dates:

#### Order before 3:00 PM on:

April 26  
May 24  
June 14  
July 12

#### Pickup by 4:00PM on:

May 6  
June 3  
June 24  
July 22

Summer Break

September 20  
October 18  
November 22

September 30  
October 28  
December 2

Note: payment must be received two days prior to delivery date.

Payment options: cash or cheque upon pick up  
e-transfer to [info@wfcss.org](mailto:info@wfcss.org)

Password: goodfoodbox (all one word, lower case)



# Did your ADDRESS Change this year?

In 2021, Canada Post changed over 1400 addresses in Wheatland County from rural route addresses to civic, or 911/blue sign, addresses.

**If Canada Post changed your mailing address, please contact us to ensure your tax account is up to date.**

We are preparing to send 2022 tax notices shortly, and it's important to have the correct address on file, as non-receipt of the tax notice doesn't exempt you from late penalties.

## To change your address:

- **Online:** Visit [www.wheatlandcounty.ca](http://www.wheatlandcounty.ca), click on 'Taxes' and select the 'Change of Mailing Address Form'. Please complete the form and email it to [tax@wheatlandcounty.ca](mailto:tax@wheatlandcounty.ca).
- **Email** us at [tax@wheatlandcounty.ca](mailto:tax@wheatlandcounty.ca).
- **Call** the County Office 403-361-2029.
- **Visit** the County Office at 242006 Range Road 243.

Please be sure to mail the original Change of Address form to the Calgary Land Titles office.

We usually only accept address changes from the Land Titles Office, but due to the changes made by Canada Post and delays at the Land Titles Office, we will accept changes directly from property owners until July 2022.

If you have not received your tax notice by mid-May, please contact the Wheatland County Office. Taxes are due June 30 and late penalties will be applied on July 1.

*Note: Under the Municipal Government Act, Section 337, a tax notice is deemed to have been received seven days after it is sent. Non-receipt of your property tax bill does not exempt you from late payment penalties.*



Newspaper? Email? Radio? Social Media?

How can we improve our communications with you?

# Survey

**Complete this 5 minute survey for a chance to win a \$100 Visa gift card!**

WE WANT  
YOUR  
FEEDBACK



## HOW TO SCAN THIS QR CODE

- 1 Open your phone camera
- 2 Tap on the notification
- 3 Complete the survey!

You can also complete it on our website: [wheatlandcounty.ca](http://wheatlandcounty.ca)

**No access to the internet?**  
Here's how you can complete the survey!

1. Call 403 - 361 - 2014
- or
2. Visit our Administration Office   
242006 Range Road 243, Wheatland County





# Wheatland MEALS ON WHEELS Frozen Program

Wheatland FCSS has partnered with Calgary Meals on Wheels Frozen Program to provide Wheatland County residents with nutritious and affordable meals. The program is available to anyone in Wheatland County regardless of age, finances or status.

All items are prepared by a Blue Ribbon chef in the most up-to-date facility for safe food production. Recipes are reviewed by a registered dietitian prior to production to ensure meals are balanced and meet dietary standards.

Frozen meal orders are placed bi-weekly. The following week orders are retrieved, sorted and stored at our office until delivery or pick up arrangements have been made.

The menu is extensive and offers a variety of entrees, soups and baked goods for individuals and families. Renal and gluten-free options are also available and we would be glad to give further information should you be interested.

Cost varies by product. Payment is by cheque or cash and is due on pick-up/delivery day.

For more information or to place an order contact Wheatland FCSS at 403-934-5335. Order forms can be found in this pamphlet and on our website.

## Order/Pick up Schedule 2022

### ORDER

### PICK UP

MAY 2  
MAY 16  
MAY 30  
JUNE 13  
JUNE 27  
JULY 11  
JULY 25  
AUGUST 8  
AUGUST 22  
**SEPTEMBER 2**  
SEPTEMBER 19  
OCTOBER 3  
OCTOBER 17  
OCTOBER 31  
NOVEMBER 14  
NOVEMBER 28  
DECEMBER 5

MAY 10  
MAY 24  
JUNE 7  
JUNE 21  
JULY 5  
JULY 19  
AUGUST 2  
AUGUST 16  
AUGUST 30  
SEPTEMBER 13  
SEPTEMBER 27  
OCTOBER 11  
OCTOBER 25  
NOVEMBER 8  
NOVEMBER 22  
DECEMBER 6  
DECEMBER 13

\* Please note that those dates highlighted are alternate order days due to statutory holidays. Please have your order in by 3PM.

**We look forward to hearing from you!**

PH: 403-934-5335

[www.wfcss.org](http://www.wfcss.org)







# COMPASS for The Caregiver

Online



Care giving can be a stressful, isolating, and overwhelming experience. Covid-19 adds to the stress level and anxiety.

The **COMPASS for the Caregiver** program helps caregivers balance their own well-being with the challenges of care giving. Join our trained facilitators as they walk us through a 4-week virtual course. Sessions will run:

|                     |                    |
|---------------------|--------------------|
| Wednesday, May 11th | 1:30 pm to 3:30 pm |
| Wednesday, May 18th | 1:30 pm to 3:30 pm |
| Wednesday, May 25th | 1:30 pm to 3:30 pm |
| Wednesday, June 1st | 1:30 pm to 3:30 pm |

If you are a resident of Wheatland County, Hussar, Rockyford, or Standard please contact Joanne Simpson (403-361-7277) or Lynn Walker (403-934-5335) for more information and to register. Wheatland FCSS will absorb the cost of registration for local residents. Residents living outside of the above municipalities will pay \$55 for registration fee and manual.

## The Loop Program



**Loop is a program run by farmers who want to make a difference.**

For more than 4 years the program has been connecting local grocery stores with local farmers to put unsold food to use as animal feed. More than 2000 farms are connected with over 200 grocery stores accross Canada, the program continus to expand including the Calgary and Edmonton regions in 2022.



*Seem too good to be true? It's for real, and we're ready to help more farms benefit from this program.*



Help us to connect farmers in your area who may be interested in joining Loop to receive free healthy feed for their animals as well as helping keep food waste out of landfills! The stores cover the cost of the program and there is no cash cost to farms... you just need a truck and/or trailer, enough happy animals to feed, and a willingness to drive to a nearby store roughly once per week. **Sign up at [loopresource.ca/forms/signup](https://loopresource.ca/forms/signup)**



Loop was built by farmers for farmers. We hope to be working with a store near you! Learn more about the program at [www.loopresource.ca](https://www.loopresource.ca) or go to [facebook.com/loopresource](https://facebook.com/loopresource).

# WHAT DO YOU NEED HELP WITH?

Whether you're just starting out, trying to expand your business, or looking for some guidance on how to sell your company, Community Futures is here for you every step of the way.



## Starting a Business

Let our team of experienced advisors help you get started.



## Growing a Business

Our team is here to ensure you have the resources & financing you need to succeed.



## Buying a Business

We can help with business planning, strategy, or securing financing.



## Digital Economy Program

The Digital Economy Program (DEP) is designed to help entrepreneurs take their businesses online. Our Digital Service Squads will guide businesses through:

- digital transformation and/or
- launching and managing their online stores.

Small business can apply to participate in one or both programs, free of charge.



## Get one-on-one support with our experienced local business specialists

## OUR SERVICES

1. Small business support and guidance.
2. Flexible financial support to start and grow your business.
3. Small business skills and training for rural entrepreneurs.

## Building our region, One Idea at a Time

Whether you need help writing your business plan, securing financing, or exploring your online marketing opportunities, our business specialists can help.

We've been helping small business owners in the Wild Rose region for over 30 years. We're business owners too - and we know what it takes - so call and book an appointment today!



## ABOUT US

Staffed by seasoned business professionals, and guided by a volunteer Board of Directors, we're more than just a business lender.

With over 30 years of experience helping rural entrepreneurs grow and thrive as small business owners, we understand where you are now, and where you want to go in the future.



Ready for the next steps? Let's chat.

**Phone**  
403.934.8888

**Website**  
[www.wildrose.albertacf.com](http://www.wildrose.albertacf.com)

**Email**  
[wildroseinfo@albertacf.com](mailto:wildroseinfo@albertacf.com)

**Office**  
101, 331 3rd Ave.  
Strathmore, Alberta

**Community Futures** Wild Rose

[www.wildrose.albertacf.com](http://www.wildrose.albertacf.com)



Prairies Economic  
Development Canada

Développement économique  
Canada pour les Prairies



# Agriculture & Environment Department

## ASB Bursary

The Wheatland County Agricultural Service Board (ASB) invites students furthering their studies in an agriculture or environmental science related field to apply for an ASB Bursary. The ASB will provide up to \$6000 in bursaries annually with a minimum award of \$500 and a maximum award of \$1500 depending upon the number of applicants that meet the criteria.

Application packages are available from the Wheatland County Administration Office or on the Wheatland County website [www.wheatlandcounty.ca](http://www.wheatlandcounty.ca)

## Roadside Haying Applications

Landowners wishing to hay municipal Right-Of-Way must submit an application and complete an Access and Work Agreement by **June 30, 2022**

For more information visit the County website or contact the Agriculture and Environment Department.



For more information contact the  
Agriculture & Environment Department  
Phone: 403-934-3321  
Email: [agandenv@wheatlandcounty.ca](mailto:agandenv@wheatlandcounty.ca)

# FIRE SAFETY



**Emergency Preparedness Week May 1 to 7, 2022**  
**Be Ready for Anything!**

## Fire Permits

A fire which is contained in an incinerator, barbeque or residential fire pit does not require a Fire Permit under **Bylaw 2019-06**. In Wheatland County a fire permit is required for any other type of controlled fire. There is no charge for a fire or fireworks permit. If conditions are breached or the weather deteriorates, permits may be cancelled at any time. Upon suspension or cancellation of any notification; which will include immediately extinguishing any fire set according to their permit.

Our Fire Bans are applicable to only our County. Other jurisdictions and Provincial Parks will have their own regulations. Refer to [albertafirebans.ca](http://albertafirebans.ca)

Fire Permit applications can be found on the County website [www.wheatlandcounty.ca/firepermits](http://www.wheatlandcounty.ca/firepermits) or email [fireservices@wheatlandcounty.ca](mailto:fireservices@wheatlandcounty.ca) for more information.

## Sky Lanterns & Fire Crackers

Wheatland County Fire Services would like to remind residents that:

- Fire Crackers and Flying Lanterns (also known as a sky lantern) are prohibited in Alberta. If you see them being used, call 911 and report it to the Fire Department immediately.
- Fireworks are regulated under Section 5.7 of the National Fire Code – Alberta Edition and a permit is required to launch fireworks.

## Smoke Alarms

Smoke alarms are a key part of a home fire escape plan. When there is a fire, smoke spreads fast. Working smoke alarms give you early warning so you can get outside quickly.

### Safety Tips

- Install smoke alarms in every bedroom. They should also be outside each sleeping area and on every level of the home. Install alarms in the basement.
- Large homes may need extra smoke alarms.
- It is best to use interconnected smoke alarms. When one smoke alarm sounds, they all sound.
- Test all smoke alarms at least once a month. Press the test button to be sure the alarm is working.
- Current alarms on the market employ different types of technology including multi-sensing, which could include smoke and carbon monoxide combined.
- Today's smoke alarms will be more technologically advanced to respond to a multitude of fire conditions, yet mitigate false alarms.
- A smoke alarm should be on the ceiling or high on a wall. Keep smoke alarms away from the kitchen to reduce false alarms. They should be at least 10 feet (3 meters) from the stove.
- People who are hard-of-hearing or deaf can use special alarms. These alarms have strobe lights and bed shakers.
- Replace all smoke alarms when they are 10 years old.





- ☐ Draw a map of your home. Show all doors and windows.
- ☐ Visit each room. Find two ways out.
- ☐ All windows and doors should open easily. You should be able to use them to get outside.
- ☐ Make sure your home has smoke alarms. Push the test button to make sure each alarm is working.
- ☐ Pick a meeting place outside. It should be in front of your home. Everyone will meet at the meeting place.
- ☐ Make sure your house or building number can be seen from the street.
- ☐ Talk about your plan with everyone in your home.
- ☐ Learn the emergency phone number for your fire department.
- ☐ Practice your home fire drill!
- ☐ Make your own home fire escape plan

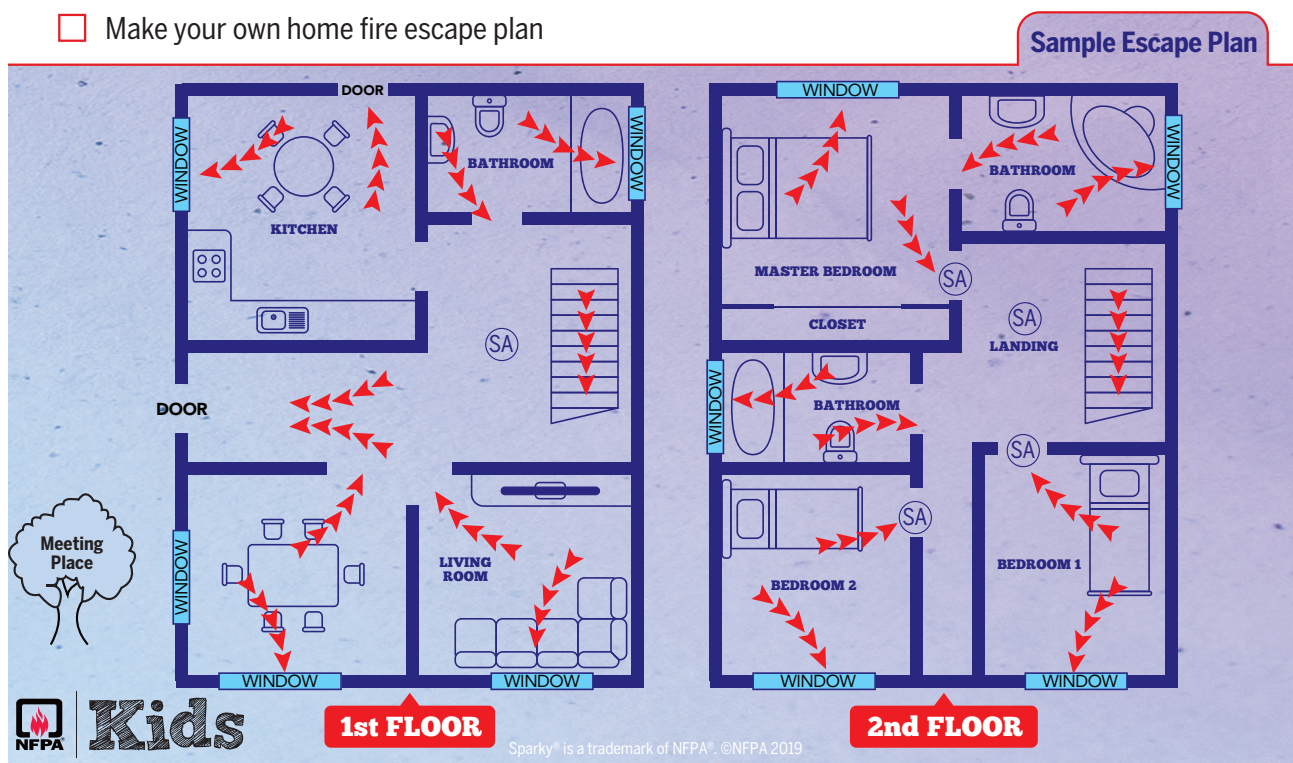



# Wildfire Risk Reduction

## 10 Safety Tips

Every year, wildfires burn across the U.S., and more and more people are living where wildfires are a real risk. But by working together, residents can make their own property — and their neighborhood — much safer from wildfire.

### Action Items to Improve Your Home's Survivability:

- **REMOVE** leaves, pine needles, and other flammable material from the roof, gutters, and on and under the deck to help prevent embers from igniting your home.
- **SCREEN** areas below decks and porches with 1/8" wire mesh to help prevent material from accumulating underneath.
- **COVER** exterior attic and soffit vents with 1/8" wire mesh to help prevent sparks from entering your home.
- **ENCLOSE** eaves to help prevent ember entry.
- **INSPECT** shingles or roof tiles. **REPLACE** missing shingles or tiles. **COVER** ends of tiles with bird stops or cement to help prevent ember penetration during a wildfire.

### Tips for Landscaping Around Your Home

- **REMOVE** dead vegetation and other flammable materials, especially within the first 5 feet of the home.
- **KEEP** your lawn hydrated and maintained. If it is brown, cut it down to help reduce fire intensity.
- **PRUNE** tree limbs so the lowest branches are 6 to 10 feet above the ground to help reduce the chance of fire getting into the crowns of the trees.
- **MOVE** construction material, trash, and woodpiles at least 30 feet away from the home and other outbuildings.
- **DISPOSE** of branches, weeds, leaves, pine needles, and grass clippings that you have cut to reduce fuel for fire.

### YOU CAN MAKE A DIFFERENCE!

Increase your wildfire safety. Make simple low-cost changes to your home and landscape starting today!

Visit **[www.firewise.org](http://www.firewise.org)** for more information.

### Driveway Etiquette

*Ensure emergency access to your property*

Driveways require a minimum of four metres (12 feet) vertical clearance and a minimum of four metres (12 feet) width to provide safety access for firefighting and other emergency vehicles.

Any driveway longer than 90 metres (300 feet) should have a turn-out space to allow fire trucks or other firefighting equipment to pass or to turn around.

Do not block your access route with gates, archways or other things that will impede the entrance of emergency vehicles.

Park your vehicles off to the side and keep clutter from blocking the driveway.

If you have a dugout or other water source like a lake or river, ensure that there is access to allow trucks to fill with water.



IT'S A BIG WORLD.  
LET'S PROTECT IT TOGETHER.®





# 2022 Property Assessment Re-Inspection Cycle

Property re-inspection is a provincial policy requiring municipalities to perform ongoing re-inspections and complete overall inspections of all properties over a five-year cycle. Wheatland County assesses residential and non-residential properties to determine their estimated market value annually, which is the basis for your property taxes.

Wheatland County Assessment Services will be performing property assessment re-inspections for the majority of improved parcels located in Range 25 (along highway 817). The hamlets of Speargrass and Gleichen will also be part of the re-inspections. The purpose of these re-inspections is to update property assessment information.

For the third year, the County is utilizing Residential Request for Information forms to streamline the re-inspection process for property owners and County Assessors. In March, a letter was sent to all residential property owners due for a re-inspection, requesting self-reporting of changes to their property. If we received a response, then the Assessor inspection will only take digital photos of the buildings.

If no response was received, then a re-inspection will require taking photographs, questions to confirm building information, and may require the buildings to be measured. Assessors will try to perform many of the inspections visually from the road; however, if the house or assessable

buildings are not clearly visible from the road, then we may perform an onsite inspection. All Assessors carry personal identification and wear a high visibility vest. The vehicle entering the yard site will be clearly marked with a Wheatland County logo and "Assessment Department." Assessors will also be adhering to all safety procedures.

The **inspections will occur during the months of June, July, August, and possibly September.** If required, a call back card may be placed on the main entrance door of the residence or another conspicuous location, to request and gather assessment information.

The Assessment Department is striving to prepare and maintain a fair and equitable property assessment base and would like to thank residents in advance for their cooperation during the 2022 assessment re-inspections.

**Should concerns arise during these inspections, please contact:**

**Dennis Klem**

**Manager of Assessment Services**

**Ph: 403-361-2009**

**Email: [dennis.klem@wheatlandcounty.ca](mailto:dennis.klem@wheatlandcounty.ca)**

# Success with ALUS Enhanced Grazing Projects

## How to establish and maintain Adaptive Multi-Paddock grazing projects



### What is Enhanced & Adaptive Multi-Paddock Grazing?

#### Enhanced Grazing

Enhanced grazing with ALUS is a suite of management tools used to catalyze accelerated grass growth and ultimately build rich, healthy soils that sequester carbon and provide many other ecological and agricultural benefits. Adaptive Multi-Paddock (AMP) Grazing is one tool to achieve these enhanced grazing outcomes. AMP grazing involves using multiple, relatively small paddocks to manage cattle grazing in high densities, followed by extended periods of rest per paddock. In some ways, this style of grazing is designed to mimic wild herds of ruminants moving across grasslands, thereby engaging the grassland ecosystem's evolved strategies to drive optimal plant growth and provide beneficial outcomes to the land and the landowner.

### What UofA research tells us:

#### Environmental Benefits of AMP Grazing

- Increased carbon sequestration
- Improved water infiltration in the soil
- Improved drought, flood and climate resilience
- Increased vegetation growth
- Improved water quality
- Increased nutrient cycling

#### What do ALUS Ranchers Say?

- Improved animal health
- Improved quantity and quality of forage
- Increased efficiency in forage utilization
- Improved nutrition
- Improved livestock handling
- Improved length of grazing season
- Improved social license

For more information visit: [grad.biology.ualberta.ca/boyce/aggp-project](http://grad.biology.ualberta.ca/boyce/aggp-project)



#### Higher Stocking Density

Enhanced grazing, and especially AMP, works when tailored to the unique conditions of the land. By observing the natural systems and adapting to their needs, AMP grazing practitioners can maximize land productivity. That's why this ALUS guide focuses on the rancher's desired outcomes to support flexibility in how the AMP grazing is executed on the ground. A hallmark of AMP grazing is careful observation and record keeping. Ranchers should observe ecological indicators to assess how well the management strategies are working. For more information, see the section Ecological Indicators to Monitor for AMP Grazing.

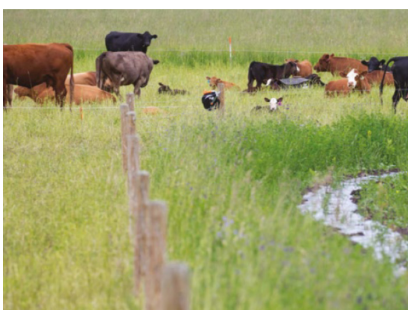

#### Smaller Paddocks

The most critical feature of AMP grazing is plenty of rest for each paddock to encourage plant recovery. Animals are not returned to the paddock until the plants have reached the correct recovery stage, which is determined by observation of plant health in the paddock. Over time, AMP grazing gives well-adapted grassland plants and plant communities the opportunity to recover, while invasive and woody species decline. The time needed for a paddock to fully recover will differ depending on the time of year, weather conditions and plant species.



#### Longer Recovery Period for Plants

The most critical feature of AMP grazing is plenty of rest for each paddock to encourage plant recovery. Animals are not returned to the paddock until the plants have reached the correct recovery stage, which is determined by observation of plant health in the paddock. Over time, AMP grazing gives well-adapted grassland plants and plant communities the opportunity to recover, while invasive and woody species decline. The time needed for a paddock to fully recover will differ depending on the time of year, weather conditions and plant species.



## AMP Grazing Infrastructure

Grazing infrastructure allows for effective management of cattle to maximize forage and ensures cattle have access to a clean water source. Simply put, paddocks and water access are the primary infrastructure required to establish an AMP grazing system.

Other important considerations may include animal shelter and livestock management tools, such as batt latches and tumble wheels. These tools can be invaluable in reducing the labour and intensive management associated with frequently moving cattle. Thoughtful paddock design makes AMP grazing management easier and helps drive the environmental and agricultural outcomes.

Each pasture and grazing system are unique. ALUS AMP grazing projects will feature a paddock setup tailored to the specific conditions of the project site. The design, infrastructure and strategies are determined by the rancher's goals, the needs of livestock and land managers.

Over time, adjustments to paddock layout are to be expected. In fact, the initial layout should be easily adapted to a complete redesign with minimal effort or added expense. Observation and adaptation are key to achieving the desired outcomes and the intent of an AMP grazing plan.

## Types of Grazing Infrastructure

### Fencing

Many grazing systems use a combination of permanent and temporary fencing. Permanent fencing is well suited to the perimeter of the pasture or field and for exclusion fencing along rivers, wetlands and other permanent waterbodies. Temporary electric fencing is useful for subdividing paddocks, providing flexibility and reduced costs. Reels and tumble wheels are tools that can simplify paddock rotation.

Tailoring the design of permanent fences to work with nature can prevent injury to wildlife and reduce damage to the infrastructure. The ideal wildlife-friendly fence has a barbless top wire no more than 40" from the ground and a bottom wire at least 18" off the ground. Highly visible wire, PVC cover or a flag on the top wire also helps wildlife to better navigate fences.



### Watering System

Many ALUS projects consist of alternate water sources like pasture pipelines, solar watering systems, portable or permanent systems that give livestock an alternative to drinking directly from a natural water body. The ecological benefits of alternate watering systems include source water protection and improved riparian health. Pasture watering systems also provide benefits to the livestock operation, such as improved herd health and increased production.

The watering system should be designed to maximize pasture utilization and provide winter watering that reduces the manure build-up associated with conventional winter corral systems. A centrally located waterer will reduce soil compaction and cattle crowding. A wellplaced watering system may be able to service multiple paddocks.

### What it Means to be Adaptive

Enhanced grazing, and especially AMP, works when tailored to the unique conditions of the land. By observing the natural systems and adapting to their needs, AMP grazing practitioners can maximize land productivity. That's why this ALUS guide focuses on the rancher's desired outcomes to support flexibility in how the AMP grazing is executed on the ground.

A hallmark of AMP grazing is careful observation and record keeping. Ranchers should observe ecological indicators to assess how well the management strategies are working. For more information, see the section Ecological Indicators to Monitor for AMP Grazing.

For more information about ALUS Adaptive Multi-Paddock Grazing Projects visit ALUS at [alus.ca/alus\\_community/alus-wheatland/](https://alus.ca/alus_community/alus-wheatland/)

# Wheatland County WEEDUCATION

## HOARY Cress

*Lepidium spp.*

### Alberta Weed Act Designation Noxious

Noxious Weeds have the ability to spread rapidly, cause severe crop losses and economic hardship. These weeds must be controlled to prevent further establishment and spread. It is a landowners duty to control this plant if it occurs on their property

Native to western Asia, Hoary Cress (whitetop, peppergrass, pepperweed) is a perennial in the Brassicaceae (Mustard) family. There are 3 similar species listed under the Weed Control Act which can be differentiated by the shape of the seed pod: *Lepidium appelianum* (globe podded); *L. chalepensis* (lens podded); and *L. draba* (heart podded). It is commonly found in parts of Wheatland County early in the growing season.

Requires full sun and moderately moist to slightly dry soils, but will tolerate alkaline soils. Repeated cultivation or mowing early in the season followed by sowing competitive grasses/legumes and herbicide, especially when used together. Mowing, cultivation, herbicide and competition.



1. Leaf

Leaves blue-green to gray-green, alternate, covered with soft white hairs, and lance-to-arrowhead-shaped; upper leaves clasp the stem, lower leaves stalked.

2. Mature Plant/ Infestation

Stems up to 60 cm tall, one to several stems per plant. Extensive, deep, creeping roots. Seeds develop in pods; the pod shape distinguishes the species of hoary cress (see above). Up to 3,500 seeds.

3. Root

Shallow and fibrous.

4. Flower

Clusters of white flowers with 4 petals create a flat-topped umbel appearance.

### Similar Species

Non-native: Other pepper-grass species (*Lepidium spp.*)

Native: Common yarrow (*Achillea millefolium*)



For more information  
Visit [www.abinvasives.ca](http://www.abinvasives.ca)



Contact George Bloom, Agricultural Services Officer for information about invasive species management in Wheatland County at Ph: 403-934-4949 or [George.Bloom@wheatlandcounty.ca](mailto:George.Bloom@wheatlandcounty.ca)



## 2022 Gravel Sales Dates

Building a road approach or upgrading your driveway? Did you know, Wheatland County residents are able to purchase crushed gravel and pitrun at a reduced cost?

Gravel tickets can be purchased at the Wheatland County Administration office from Monday – Friday between the hours of 8:00 am and 4:30 pm., applications are available on the Wheatland County website at [wheatlandcounty.ca/documents/gravel-sales/](http://wheatlandcounty.ca/documents/gravel-sales/).

**Residents will be able to redeem their gravel tickets between 8:00 a.m. and 4:00 p.m. on the set days and locations as outlined below:**

### **June 15th and 16th, 2022**

Goldsmith Pit (Cluny)  
Located at NE-8-22-21-W4  
7/8" Crush & Pit Run

### **July 5th and 6th, 2022**

Christensen Pit (Carseland)  
Located at NE-03-22-25-W4  
3/4" Crush & Pit Run

### **August 9th and 10th, 2022**

Fish Lake Pit (Dalum)  
Located at NE-28-26-18-W4  
7/8" Crush & Pit Run

## Dust Control

Wheatland County is now accepting applications for Dust Control. Prices and deadlines are as follows.

| Calcium Chloride                         |   |
|--|---|
| Spring application order deadline        | May 20, 2022  |
| Fall application order deadline          | August 19, 2022   |
| Prices                                   | County Roads: \$5.33/meter (\$1.63/linear foot) plus GST  |
| Oiling                                   |   |
| Deadline                                 | July 8, 2022 (application order deadline)   |
| County Roads New Application             | \$22.40/meter (\$6.83/linear foot) plus GST   |
| County Roads Redo                        | \$18.65/meter (\$5.68/linear foot) plus GST<br>Redo rates apply if dust control has been done in the previous 10 years on the same site and at the County's discretion. |
| Gravel Secondary Highway New Application | \$25.68/meter (\$7.83/linear foot) plus GST   |
| Gravel Secondary Highways Redo           | \$21.93/meter (\$6.68/linear foot) plus GST<br>Redo rates apply if dust control has been done in the previous 10 years on the same site and at the County's discretion. |

- Payment must be received with completed application(s).
- Dust Control will only proceed if there is sufficient interest.
- Minimum order 122 meters (400 ft.).
- Wheatland County applies a one-time double spray application of calcium chloride for all purchased calcium dust controls.
- Applications are available at the County office or on the County website [www.wheatlandcounty.ca](http://www.wheatlandcounty.ca)





Wheatland County  
242006 Range Road 243  
Wheatland County, AB T1P 2C4

T: 403-934-3321 F: 403-934-4889  
[wheatlandcounty.ca](http://wheatlandcounty.ca)  
[@wheatlandcounty](https://www.instagram.com/wheatlandcounty)

